

Installation Guide

Spacelabs Channel-mounted Power Supply Bracket

The purpose of this guide is to describe channel mounting of a typical power supply.

Parts Reference

The following parts and hardware are included with this installation kit:

| Item # | Description | Qty |
|--------|---|-----|
| 1 | Power Supply Bracket (with 17" Hook & Loop Straps) | 1 |
| 2 | Adjustable Stop | 1 |

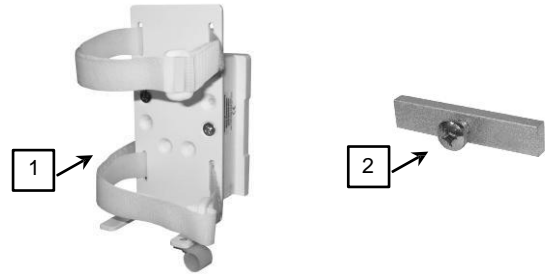

Tools Required

- Phillips screwdriver (not provided)
- Scissors (not provided)

Mounting the Power Supply

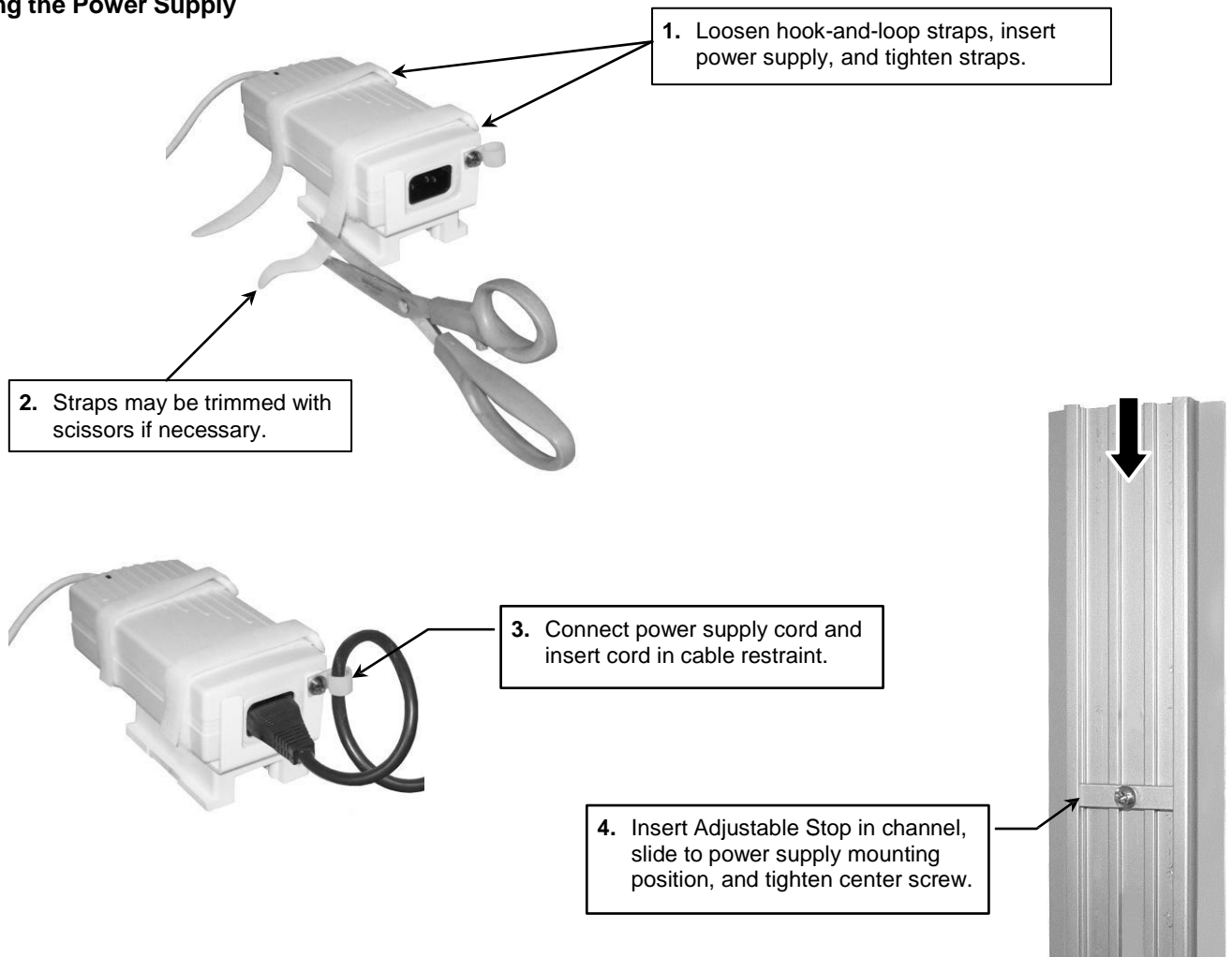

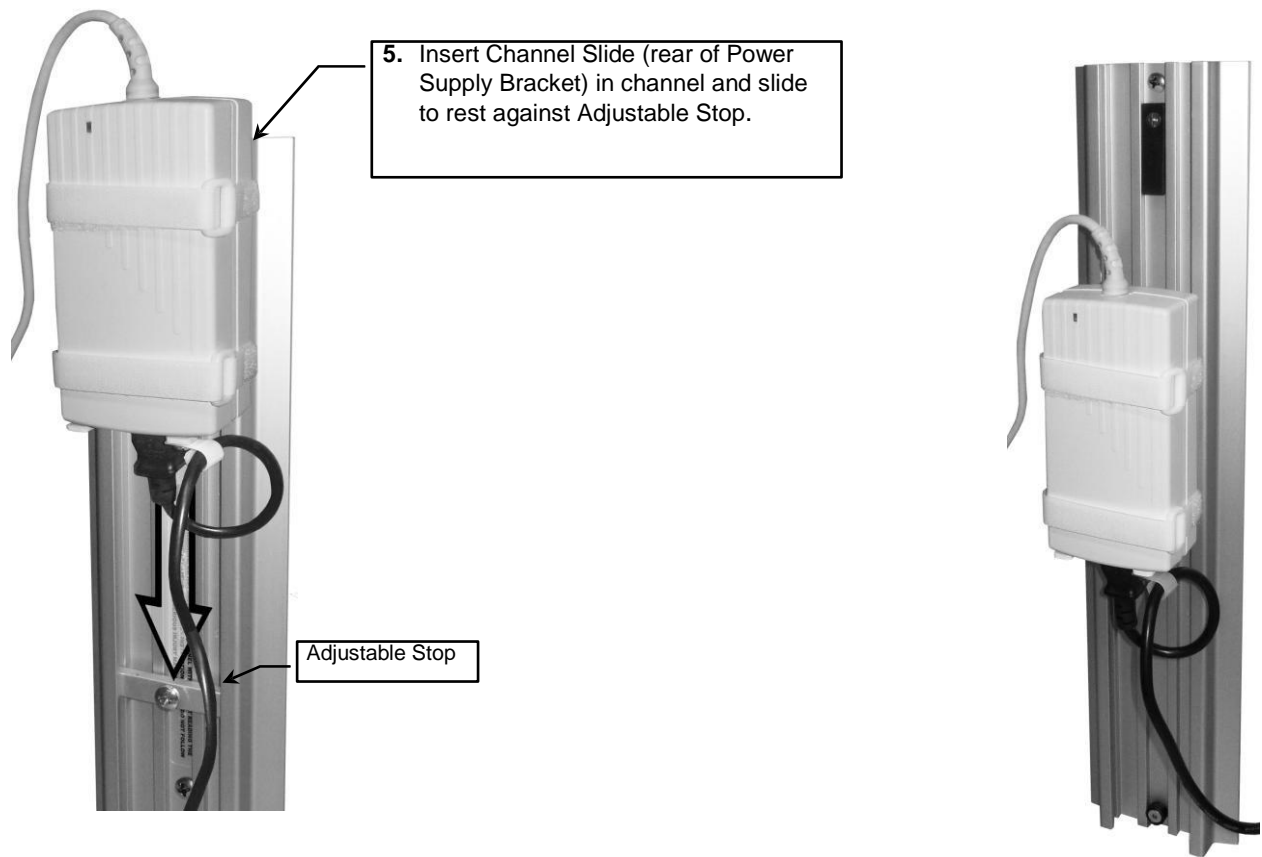

Routine Maintenance

Periodically inspect all hardware associated with the mounting system. Tighten or adjust as necessary for optimal operation and safety.

Cleaning the Mounting Assembly

1. The mounting assembly may be cleaned with most mild, non-abrasive solutions commonly used in the hospital environment (e.g. diluted bleach, ammonia, or alcohol solutions).
2. The surface finish will be permanently damaged by strong chemicals and solvents such as acetone and trichloroethylene.
3. Do not use steel wool or other abrasive material to clean the mounting assembly.
4. Damage caused by the use of unapproved substances or processes will not be covered by warranty. We recommend testing of any cleaning solution on a small area of the mounting assembly that is not visible to verify compatibility.
5. Do not submerge or allow liquids to enter the mounting assembly. Wipe any cleaning agents off immediately using a water-dampened cloth. Dry the mounting assembly thoroughly after cleaning.

CAUTION: GCX makes no claims regarding the efficacy of the listed chemicals or processes as a means for controlling infection. Consult your hospital's infection control officer or epidemiologist. To clean or sterilize mounted instruments or accessory equipment, refer to the specific instructions delivered with those products.