

Installation Guide

18 x 16.5"/45.7 x 41.3cm Tray for M Series Arms

Refer to qualified personnel for assembly and installation

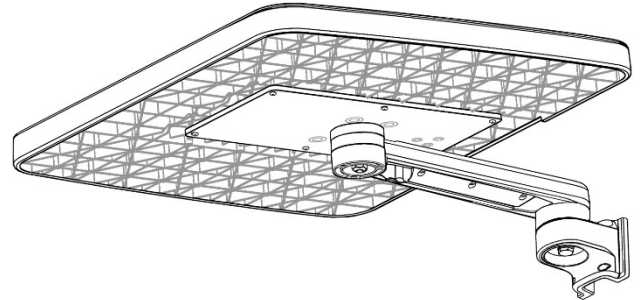

The purpose of this guide is to describe installation of Tray to M Series Arm.

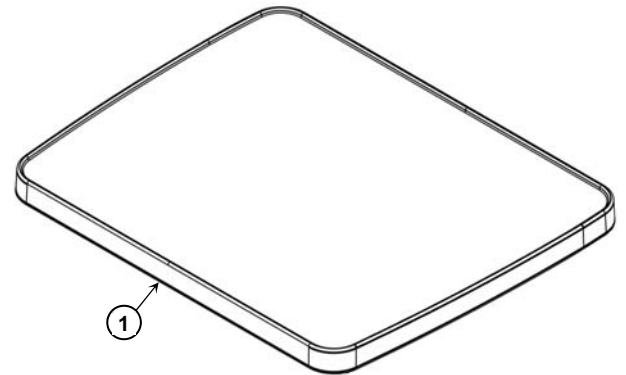

Parts Reference

The following parts and hardware are included in this installation kit:

Item #	Description	Qty
1	Tray	1
2	Mounting Plate with Swivel Head	1
3	Swivel Cup	1
4	Nylon Washer	1
5	Swivel Washer	1
6	Flat Washer	1
7	5/16-18 Lock Nut	1
8	10-32 x 5/8" Pan Head Machine Screw (PHMS)	6

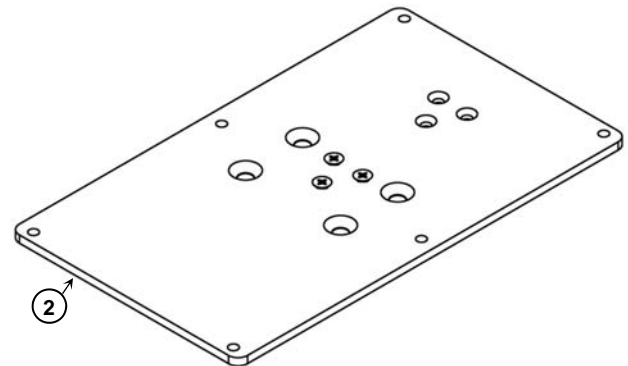

Tools Required

- 1/2" / 13mm socket wrench (provided)
- Phillips screwdriver (not provided)

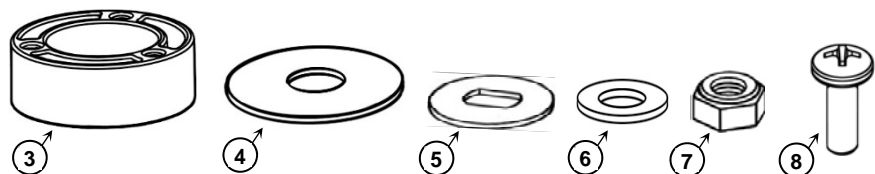

Installing Mounting Plate on M Series Arm

Installation Note: If using 8"/20.3cm M Series Arm see page 3.

1. Remove the Nyliner bushing from the front end of the M Series Arm and set aside.

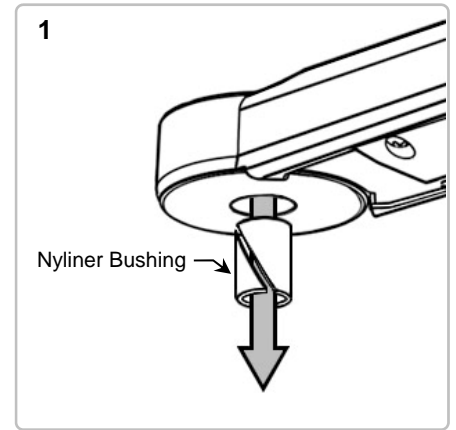

2. (1) Install Nylon washer and the Nyliner bushing on to the mounting stud as shown.

3. Assemble the Mounting Plate to the M Series Arm with one (1) Nylon Washer, Swivel Cup, Swivel Washer, M8 Flat Washer, and 5/16-18 Lock Nut using a 1/2"/13mm socket wrench, as shown below. Make sure that the flat sides inside the Swivel washer slide on to the corresponding sides on the Mounting Stud. Tighten or loosen the Lock Nut to set swivel tension of the Tray. This 5/16-18 lock nut must be torqued to a minimum of 20 in-lbs. / 2.3 Nm.

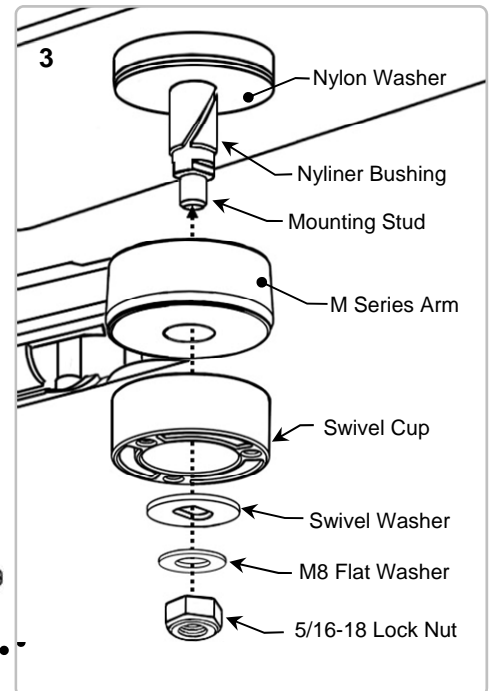
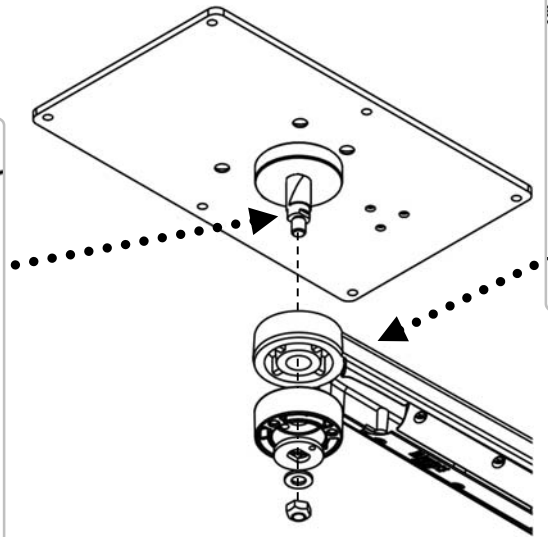
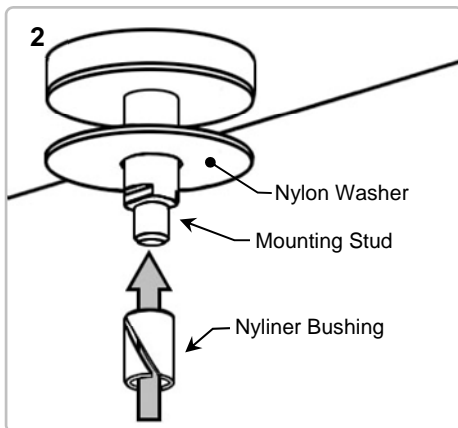

Warning: The 5/16-18 lock nut must be torqued to a minimum of 20 in-lbs. / 2.3 Nm.

Installing Tray on M Series Arm

1. Attach Mounting Plate to Tray with six (6) #10-32 x 5/8" PHMS.

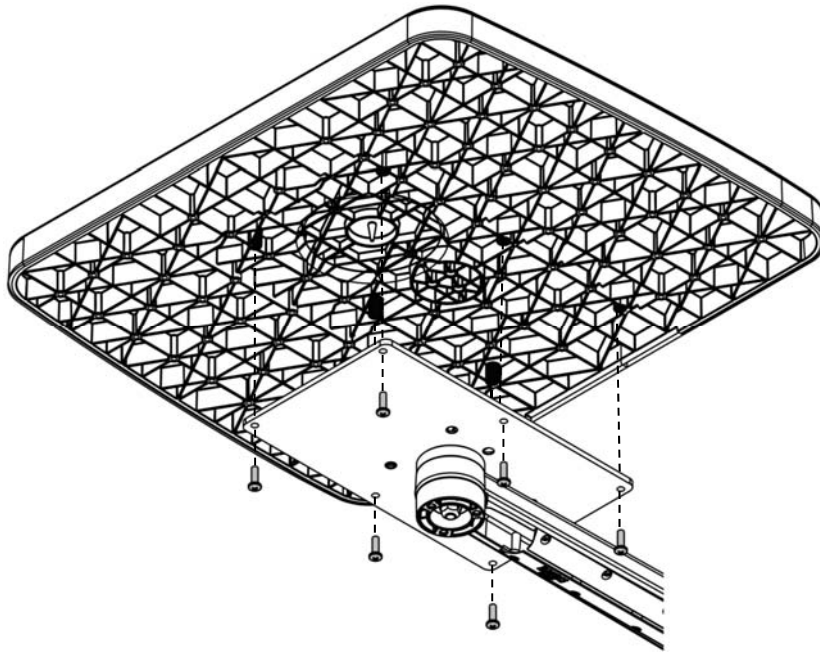

Changing Swivel Position

1. Using a Phillips screwdriver, remove six (6) #10-32 x 5/8" Pan Head Machine Screws (PHMS) from Mounting Plate and set aside.
2. Remove three (3) #10-32 x 1/2" Flat Head Machine Screws (FHMS) from top of Plate

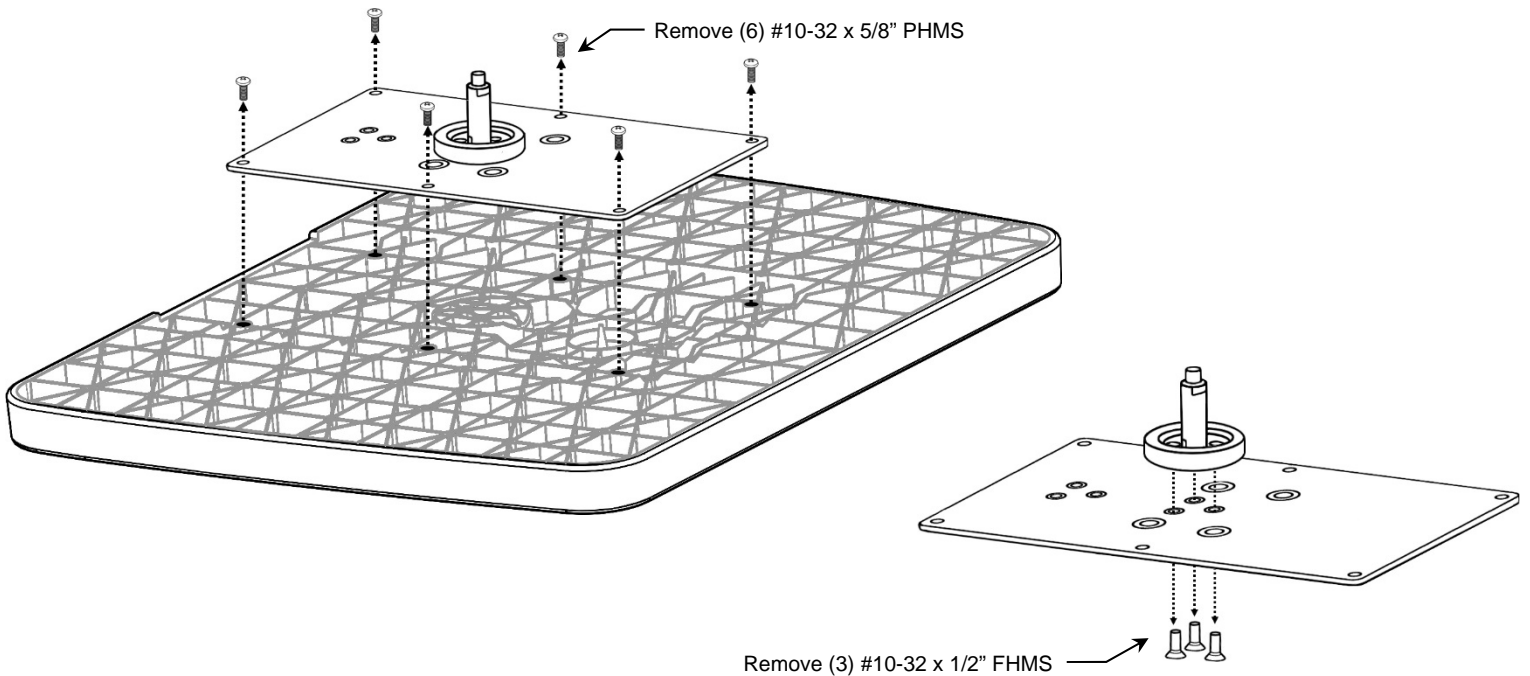

3. Align the three upper mounting holes on Mounting Plate with the three corresponding mounting holes on the Swivel Head. Secure the Swivel Head to the Mounting Plate with three (3) #10-32 x 1/2" FHMS.
4. Reattach Mounting Plate to Tray with six (6) #10-32 x 5/8" PHMS.

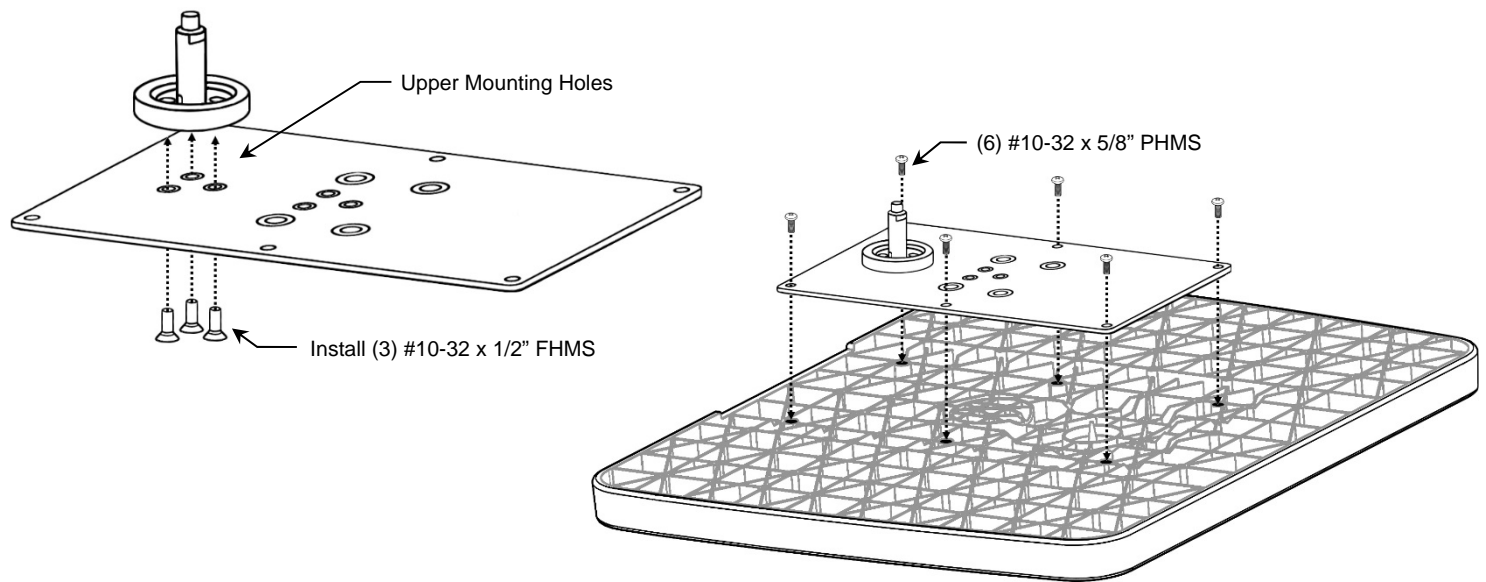

5. Install Tray to M Series Arm as instructed on page 2.

Routine Maintenance

Periodically inspect all fasteners associated with the mounting system. Tighten or adjust fasteners as necessary for optimal operation and safety.

Cleaning the Mounting Assembly

1. The mounting assembly may be cleaned with most mild, non-abrasive solutions commonly used in the hospital environment (e.g. diluted bleach, ammonia, or alcohol solutions).
2. The surface finish will be permanently damaged by strong chemicals and solvents such as acetone or trichloroethylene.
3. Do not use Steel wool or other abrasive material.
4. Damage caused by the use of unapproved substances or processes will not be warranted. It is recommended that you test any cleaning solution on a small area of the mounting assembly that is not visible to verify compatibility.
5. Never submerge or allow liquids to enter the mounting assembly. Wipe any cleaning agents off of the mounting assembly immediately, using water dampened cloth. Dry the assembly thoroughly after cleaning.

CAUTION: GCX makes no claims regarding the efficacy of the listed chemicals or processes as a means for controlling infection. Consult your hospital's infection control officer or epidemiologist. To clean or sterilize mounted devices or accessory equipment, refer to the specific instructions delivered with those products.