

Installation Guide

VHM Arm with VESA Mounting Plate and Left or Right Rotation Stop

The purpose of this guide is to describe mounting of VHM Arm and installation of Rotation Stop Screw.

Parts Reference

The following parts and hardware are included with this installation kit (hardware not shown):

Item #	Description	Qty
1	VHM Arm (Includes Installation Guide)	1
2	Height Locking Lever	1
3	#10-32 x 3/8" SHCS	1
4	5/32" Hex Wrench	1
5	1/8" Hex Wrench	1
6	1/2" Socket Wrench	1

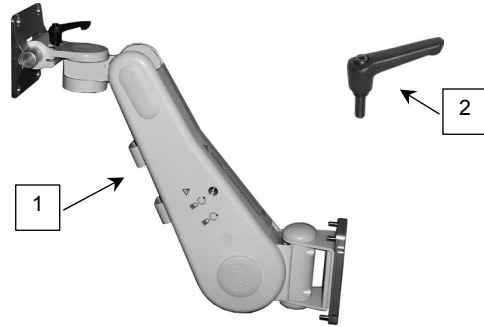

Tools required: 1/8" and 5/32" hex wrenches (provided); 1/2" socket wrench (provided), and Phillips screwdriver (not provided).

Installation Note

Install Arm and Rotation Stop Screw according to this installation guide. After installing the Arm, please refer to *Installation & Operation Manual for VHM™ Series Arms (DU-WS-0001)*. This installation guide covers display-mounting and important procedures for optimal operation of the VHM Arm.

Installing the VHM Arm

1. Thread Height Locking Lever into mounting hole in right side of Arm. The Lever operates by turning clockwise to tighten or counterclockwise to loosen. Ensure Locking Lever is in locked position before mounting Arm in channel.



Mounting VHM Arm in Left Side Channel & Installing Rotation Stop Screw

1. Insert the Slide (rear of VHM Arm) into the Channel. Using the 1/8" hex wrench provided, tighten four (4) set screws in the Slide.
2. Remove Pivot Cap from upper Pivot Bracket at rear of VHM Arm and ensure Arm is perpendicular to channel. Using the 5/32" hex key provided, install Rotation Stop Screw (#10-32 x 3/8" SHCS) in threaded hole nearest front of machine (below right). Replace Pivot Cap.

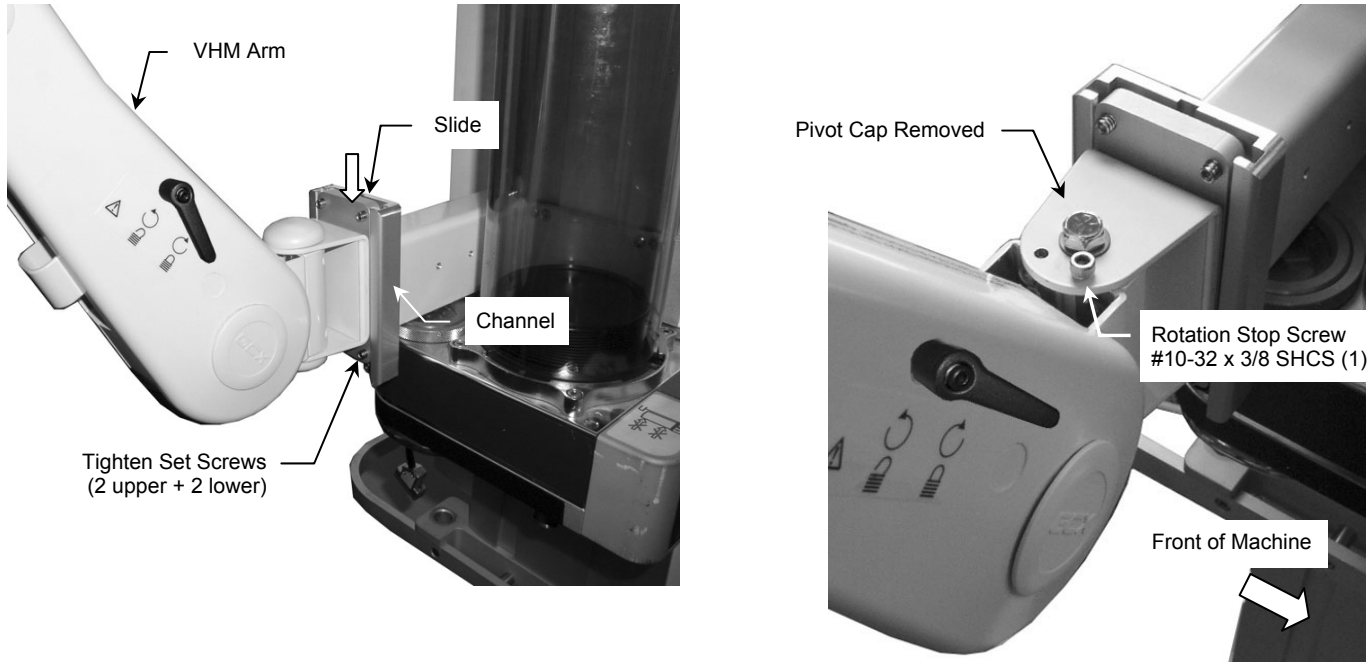

Mounting VHM Arm in Right Side Channel & Installing Rotation Stop Screw

1. Mount Arm as in step 1 above.
2. Remove Pivot Cap from upper Pivot Bracket at rear of VHM Arm and ensure Arm is perpendicular to channel. Using the 5/32" hex key provided, install Rotation Stop Screw (#10-32 x 3/8" SHCS) in threaded hole nearest front of machine (see below). Replace Pivot Cap.

