

GCX Mounting Assembly Installation Guide

Datex-Ohmeda S/5 Frame Unit Hanger Assembly and Extension Posts for M-Series Arm

The purpose of this guide is to:

1. Describe the procedure for attaching an extension post to the hanger assembly.
2. Describe the procedure for attaching the hanger assembly to the arm.
3. Describe the procedure for mounting the S/5 Frame Unit in the hanger.

Parts Reference

The following parts and hardware are included with this installation kit (see photo for parts, hardware not shown):

Item Description	Qty
Hanger Assembly	1
3.5" Extension Post	1
8" Extension Post	1
Lower Post Disc	1
M6 x 35 mm Pan Head Machine Screw (PHMS)	2
1/4" Split Lock Washer	2
#10-32 x 5/8" Flat Head Machine Screw (FHMS) – Post to Hanger	3
#10-32 x 5/8" FHMS (100°) – Disc to Post	3
#10-32 x 3/8" Socket Head Cap Screw (SHCS) – Disc to Arm	3
5/32" Hex Wrench	1

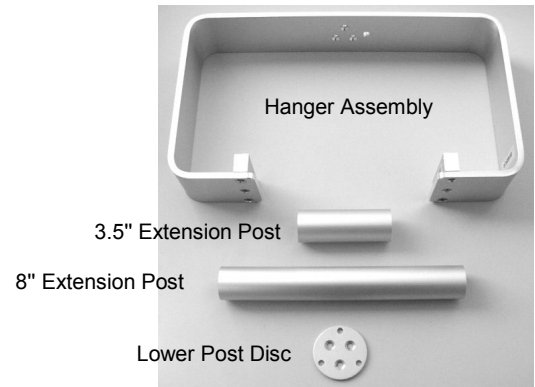

Tools Required: Phillips screwdriver, 5/32" hex wrench (provided).

Attaching an Extension Post to the Hanger Assembly

1. Select the required Extension Post (3.5" or 8") and attach it to the Hanger Assembly using three (3) #10-32 x 5/8" FHMS.
2. Attach the Lower Post Disc to the Extension Post using three (3) #10-32 x 5/8" FHMS (100°).

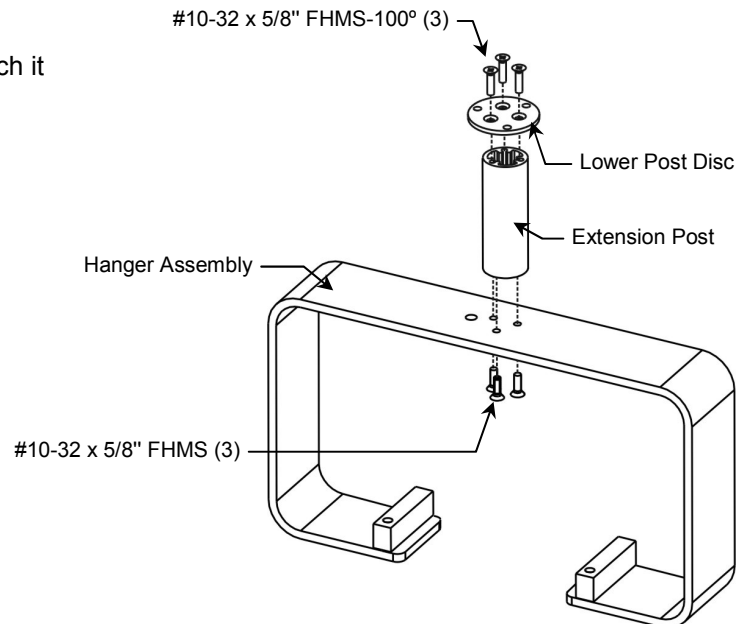

Attaching the Hanger Assembly to the M-Series Arm

Installation Note: The two (2) mounting holes on the Spacer Bars must be oriented toward the front of the S/5 Frame Unit (see drawing below) to ensure correct weight distribution in the Hanger. This may be accomplished by 1) alignment when Hanger is attached to Arm, or 2) by swiveling the Hanger after attachment to the Arm.

1. Remove the round plastic bolt cap from the bottom of the front end of the arm (not shown).
2. Using the 5/32" hex wrench, attach the Hanger Assembly to the Arm with three (3) #10-32 x 3/8" SHCS.

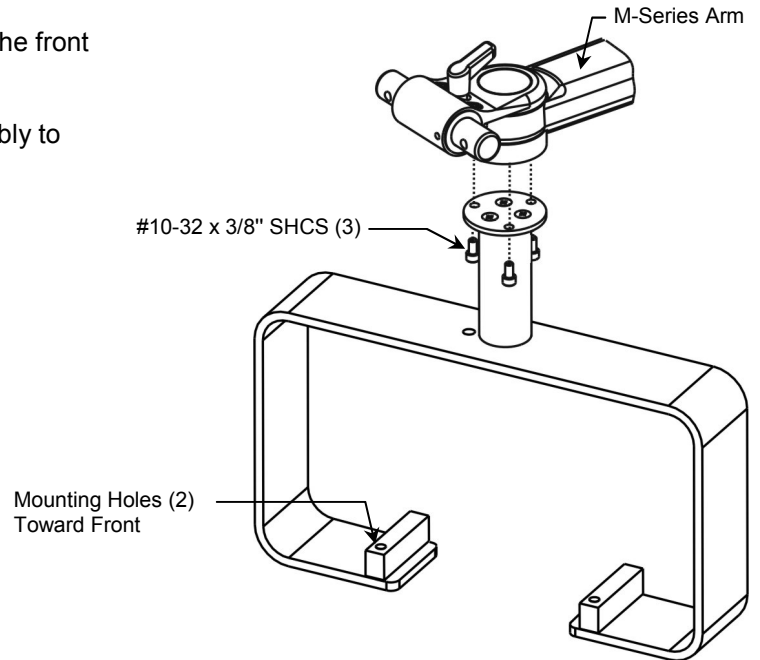

Mounting the S/5 Frame Unit in the Hanger

1. Locate the two (2) inner threaded mounting holes shown below on the bottom of the S/5 Frame Unit housing. These holes will be used for attachment to the Hanger.

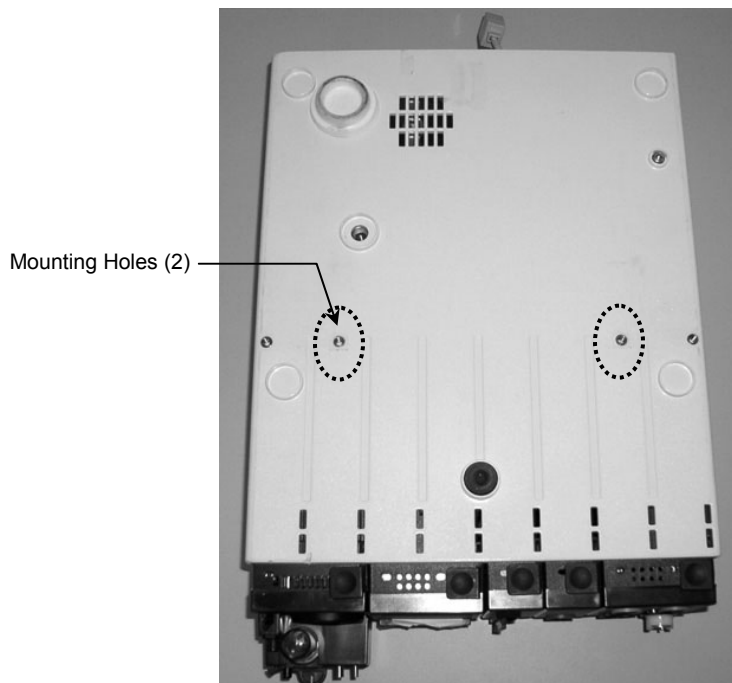

2. Ensure that the two (2) mounting holes in the Hanger are oriented toward the front of the S/5 Unit and slide the Unit into the Hanger (left photo).
3. Align the two (2) mounting holes in the bottom housing with the mounting holes in the Hanger. Secure the S/5 Frame Unit in the Hanger with two (2) M6 x 35 mm PHMS (right photo).

