

GCX Mounting Assembly Installation Guide

Dräger Fabius GS Extension Block for Mounting M-Series Arm, IV Pole, or Dräger Circuit Arm

The purpose of this guide is to:

1. Describe assembly of M-Series Arm on Extension Block.
2. Describe installation of Extension Block/Arm assembly in Channel.
3. Describe installation of Dräger Circuit Arm on Extension Block

Parts Reference

The following parts and hardware are included with this installation kit (see photos for parts; tools & hardware not shown):

Item #	Part Description	Qty
1	Extension Block	1
2	1/8" Hex Key	1
3	3/16" Hex Key	1

Extension Block

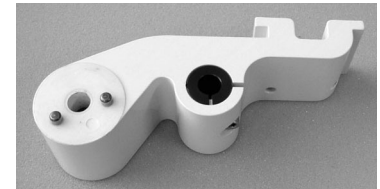

Tools Required: 1/2" [13mm] socket wrench or nut driver, 1/8" and 3/16" hex keys (provided).

Assembling M-Series Arm on Extension Block

1. Remove the 5/16-18 hex bolt, lock washer, large steel washer, and Nylon washer from the M-Series Arm (below left). This hardware will be used to fasten the Arm to the Extension Block in Step 3.

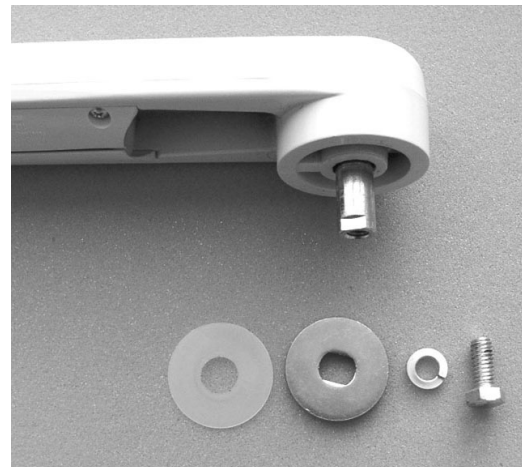
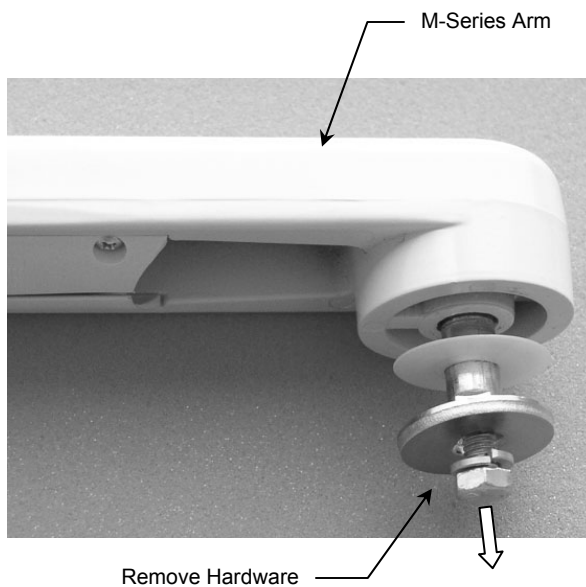

2. Locate two (2) Stop Pins on top of Extension Block (below left). Turn the M-Series Arm upside down and locate the Center Rib adjacent to the Pivot Pin (below right). Insert the Pivot Pin in the Pivot Block so the Center Rib is positioned between the Stop Pins. **Installation Note:** Ensure that the Plastic Washer (installed over Stop Pins) and Bushing (inside Pivot Block) stay in place.

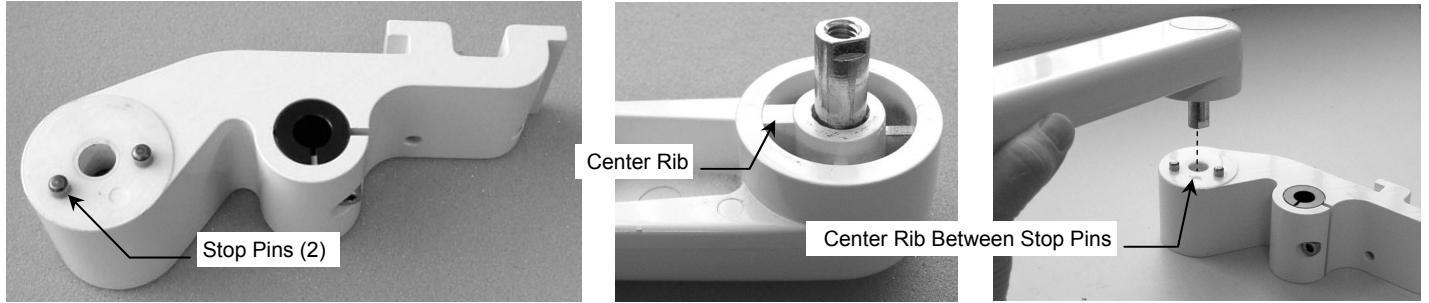

3. Fasten Arm to Extension Block with the 5/16-18 hex bolt, lock washer, large steel washer, and Nylon washer as shown from left to right in photos below. Tighten the 5/16-18 Hex Bolt so arm rotates smoothly. **Installation Note:** Arm will only rotate 20 degrees to minimize the potential for tipping of the anesthesia machine.

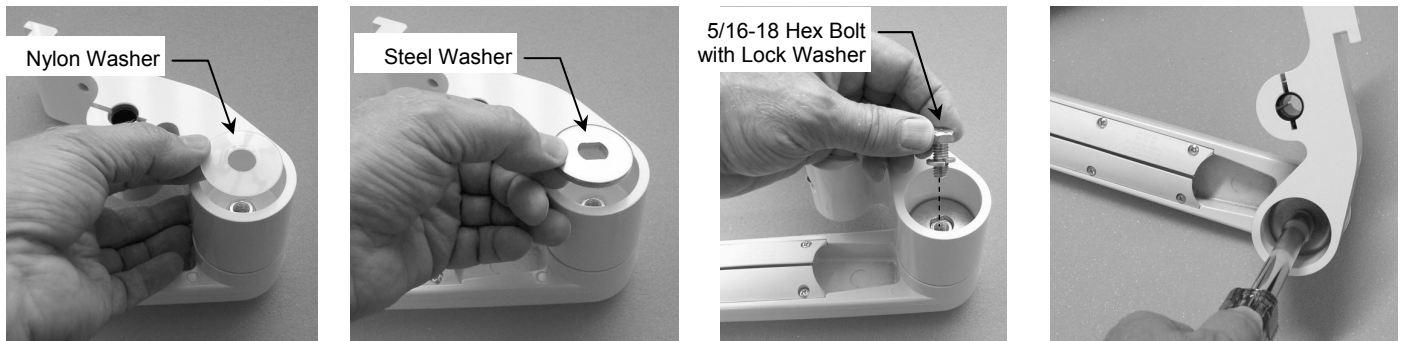

Mounting Extension Block in Channel

1. Insert the Slide into the opening in the Channel (below left). Move the Extension Block up the Channel to the Arm-mounting position and tighten the two 1/4-20 Set Screws with the 1/8" hex key provided (below right). **Installation Note:** Refer to separate installation guide *DU-WMM-0001* for M-Series Arm operating Instructions.

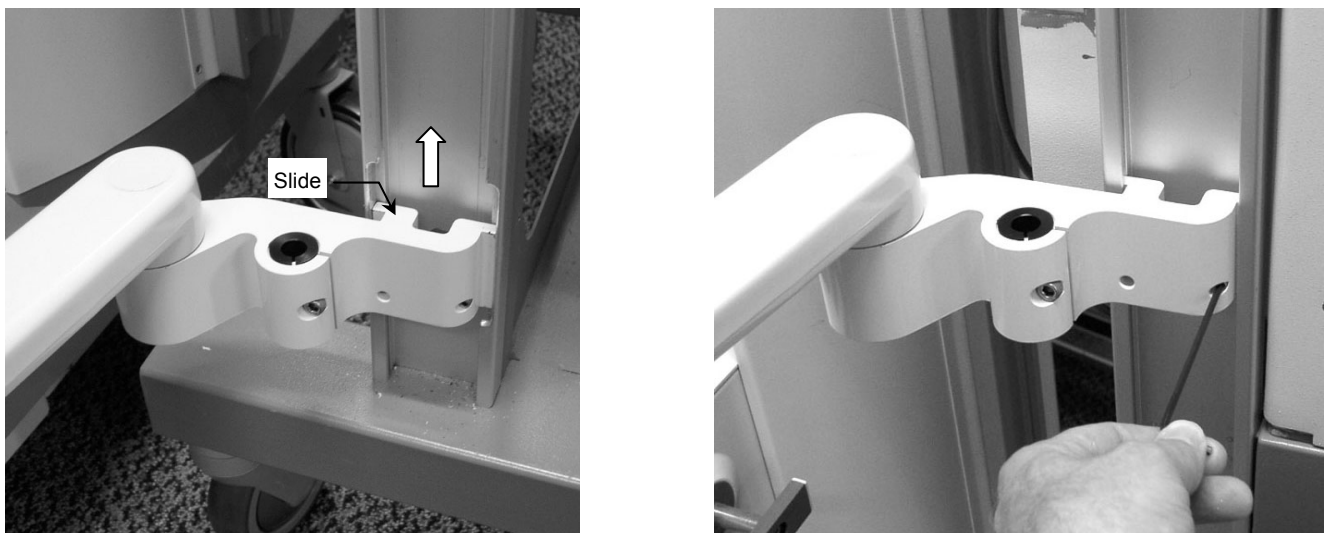

Installing Dräger Circuit Arm on Extension Block (Optional)

1. Insert Circuit Arm into Extension Plate Bushing as shown below left.
2. Using the 3/16" hex key provided, tighten the M6 socket head cap screw (SHCS) to adjust swivel tension.

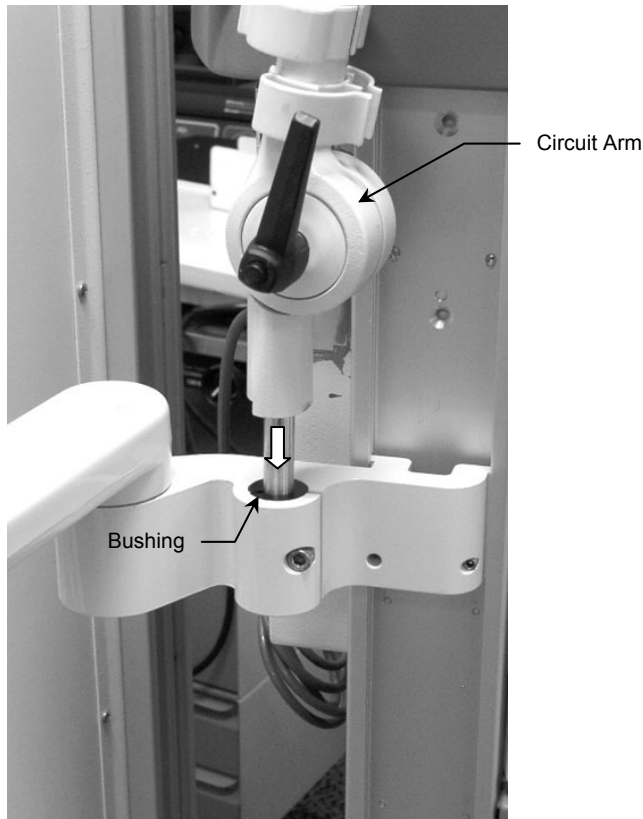

Routine Maintenance

Periodically inspect all hardware associated with the mounting system. Tighten or adjust as necessary for optimal operation and safety.

Cleaning the Mounting Assembly

1. The mounting assembly may be cleaned with most mild, non-abrasive solutions commonly used in the hospital environment (e.g. diluted bleach, ammonia, or alcohol solutions).
2. The surface finish will be permanently damaged by strong chemicals and solvents such as acetone and trichloroethylene.
3. Do not use steel wool or other abrasive material to clean the mounting assembly.
4. Damage caused by the use of unapproved substances or processes will not be covered by warranty. We recommend testing of any cleaning solution on a small area of the arm that is not visible to verify compatibility.
5. Do not submerge or allow liquids to enter the arm. Wipe any cleaning agents off of the arm immediately using a water-dampened cloth. Dry the arm thoroughly after cleaning.

CAUTION: GCX makes no claims regarding the efficacy of the listed chemicals or processes as a means for controlling infection. Consult your hospital's infection control officer or epidemiologist. To clean or sterilize mounted instruments or accessory equipment, refer to the specific instructions delivered with those products.