

Installation Guide

M Series Articulating Arm with Stor-Locx Storage Module (Non-locking)

**Weight Capacity:**

Overall: 20 lb / 9.1 kg total including cassette contents

Cassette Contents: 7.5 lb / 3.4 kg maximum

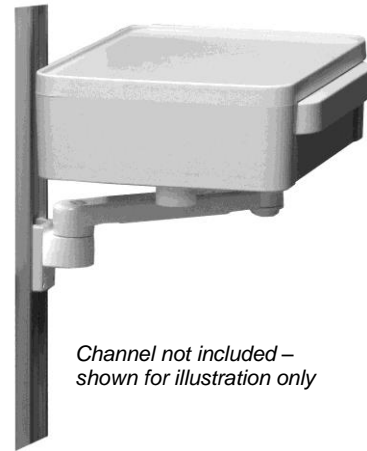

*Channel not included –
shown for illustration only*

Parts Reference

The following parts and hardware are included with this installation kit (hardware not shown):

Item #	Description	Qty
1	Complete Assembly	1
2	1/8" / 3mm Hex Wrench	1
3	1/2" / 13mm Socket Wrench	1

Tools Required: 1/8" Hex Wrench (included), 1/2" Socket Wrench (included)

Routine Maintenance

Periodically inspect all mounting hardware. Tighten or adjust as necessary for optimal operation and safety.

Installing Arm in Channel

1. Install Adjustable Stop in top of Channel, slide to bottom of Channel and tighten center screw.
2. While supporting the bottom of the Arm and Assembly, guide the Slide (rear of Arm) into top of the Channel.
3. Guide Arm to desired height and tighten two (2) set screws with 1/8" [3 mm] hex wrench (provided).

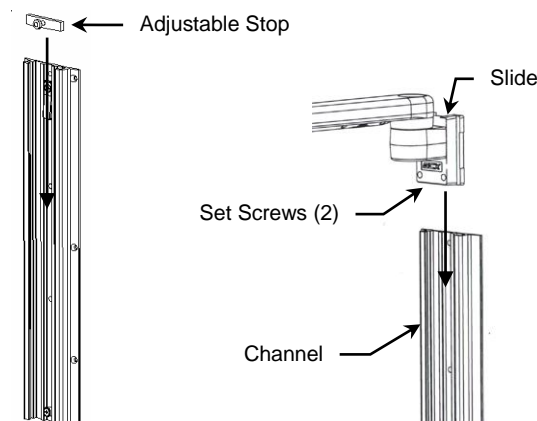

Pivot & Pivot Tension

Articulating Arm – Dual Pivot Points

1. To pivot the Arm at the Slide, simply push on the side of the Arm or Stor-Locx.
2. To pivot the Arm at the midway pivot point, simply push on the side of the front Arm Stor-Locx while holding the rear arm in place.
3. To adjust the pivot tension at the Slide, tighten or loosen the Pivot Tension Bolt with a $\frac{1}{2}$ " / 13 mm socket wrench.
4. To adjust the pivot tension, tighten or loosen the mid-point Pivot Tension Bolt with a $\frac{1}{2}$ " / 13 mm socket wrench.

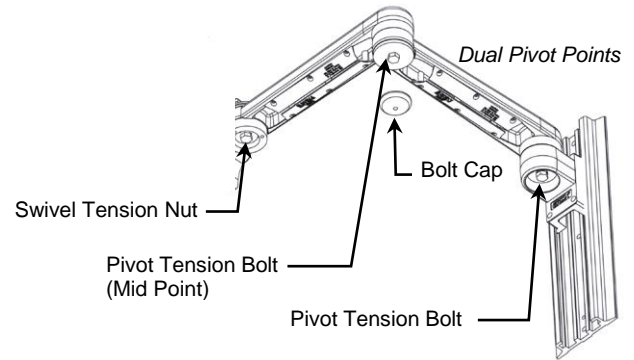

Swivel & Swivel Tension

1. In most configurations, the mounted device will swivel at the end of the Arm. To rotate the device simply push or pull the corners of the device.
2. To adjust the swivel tension, tighten or loosen the Swivel Tension Nut with a $\frac{1}{2}$ " / 13 mm socket wrench.

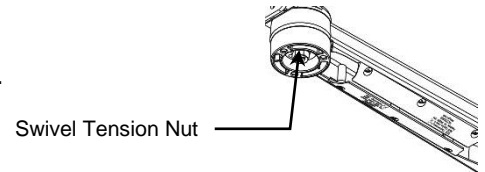

Stor-Locx Storage Module with Work Surface

Removing the Cassette:

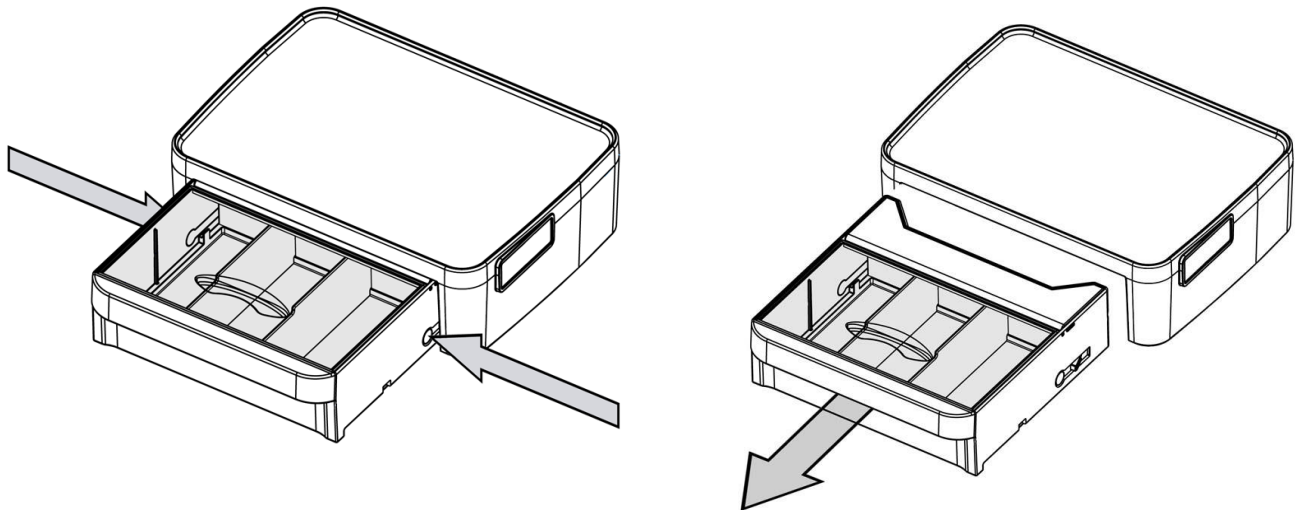

Removing Cassette Dividers:

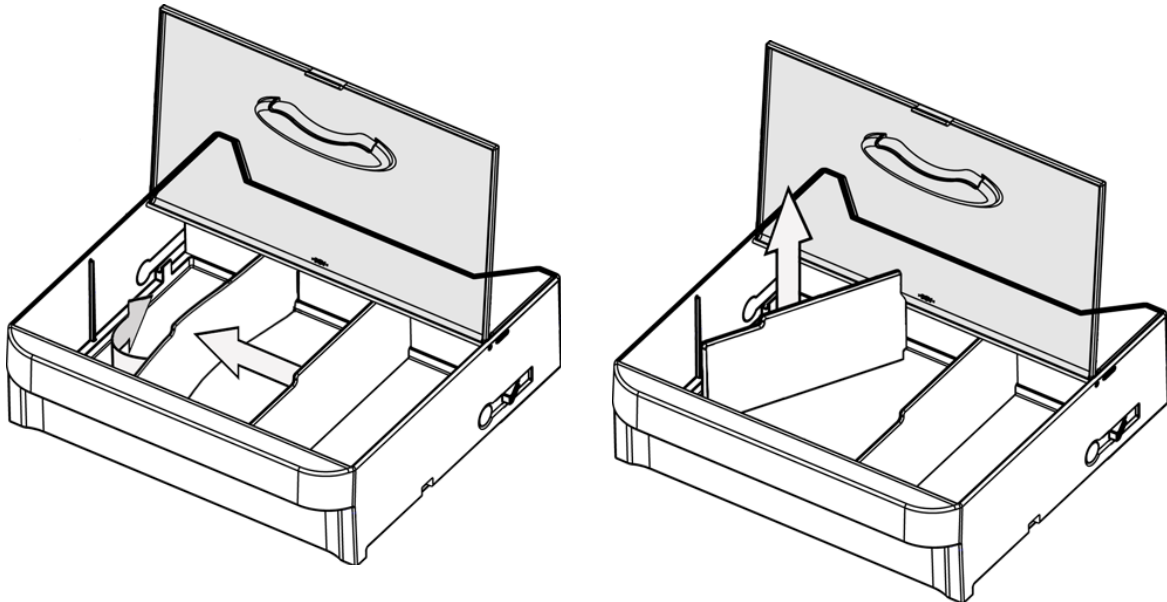

Cleaning the Mounting Assembly

CAUTION: GCX makes no claims regarding the efficacy of the listed chemicals or processes as a means for controlling infection. Consult your hospital's infection control officer or epidemiologist. To clean or sterilize mounted instruments or accessory equipment, refer to the specific instructions delivered with those products.

1. The mounting assembly may be cleaned with most mild, non-abrasive solutions commonly used in the hospital environment (e.g. diluted bleach, ammonia, or alcohol solutions).
2. The surface finish will be permanently damaged by strong chemicals and solvents such as acetone and trichloroethylene.
3. Do not use steel wool or other abrasive material to clean the mounting assembly.
4. Damage caused by the use of unapproved substances or processes will not be covered by warranty. We recommend testing of any cleaning solution on a small area of the mounting assembly that is not visible to verify compatibility.
5. Never submerge or allow liquids to enter the mounting assembly. Wipe any cleaning agents off the mounting assembly immediately using a water-dampened cloth. Dry all mounting assemblies thoroughly after cleaning.