

**Installation Guide**

**Philips MP90 Mounting Kit for Flat Panel Displays, Remote Speedpoint and External Alert**

The mounting brackets in this installation kit are designed to allow the Remote Speedpoint and External Alert Device to be mounted on the right or left side of the 15" (M8031B) and the 19" (865299) display. Only right side mounting is shown in this installation guide but left side mounting is accomplished by flipping parts to the opposite side.



**Table of Contents**

<b>Section 1.0</b>	Parts & Installation Reference.....	2
<b>Section 2.0</b>	Attaching Remote Bracket and Mounting 15" (M8031B) Display.....	3
<b>Section 3.0</b>	Attaching Remote Bracket and Mounting 19" (865299) Display.....	4
<b>Section 4.0</b>	Attaching Alert Bracket and Reinforcing Bar to Remote Bracket.....	5
<b>Section 5.0</b>	Mounting the Devices and Power Supply Holster.....	6
<b>Section 5.1</b>	Mounting External Alert Device.....	6
<b>Section 5.2</b>	Mounting the Remote Speedpoint.....	7
<b>Section 5.3</b>	Attaching Power Supply Holster (supplied with display) to Remote Bracket.....	8

## Section 1.0 Parts & Installation Reference

### Parts Reference

The following parts and hardware are included in this installation kit (hardware not shown):

Item #	Description	Qty
1	Remote Bracket	1
2	Alert Bracket	1
3	Remote Speedpoint Adapter	1
4	Reinforcing Bar	1
5	VESA Mounting Adapter 100mm to 75mm	1
6	Spacer, 19" Display Mounting (P/N AG0019S22A)	1
7	Spacer, 15" Display Mounting (P/N AG0019S15A)	1
8	M4 x 6mm Flat Head Machine Screw (FHMS)	2
9	M4 x 8mm Pan Head Machine Screw (PHMS)	10
10	M4 x 10mm PHMS	2
11	M4 x 12mm PHMS	4
12	M4 x 16mm PHMS	2
13	M4 x 16mm FHMS	3
14	M4 x 20mm FHMS	2
15	M4 x 25mm FHMS	4
16	M4 x 40mm FHMS	2
17	Alert Spacer, 1.25" Aluminum	2
18	Spacer, 1/2" Nylon	2
19	#8 retention Washer	2

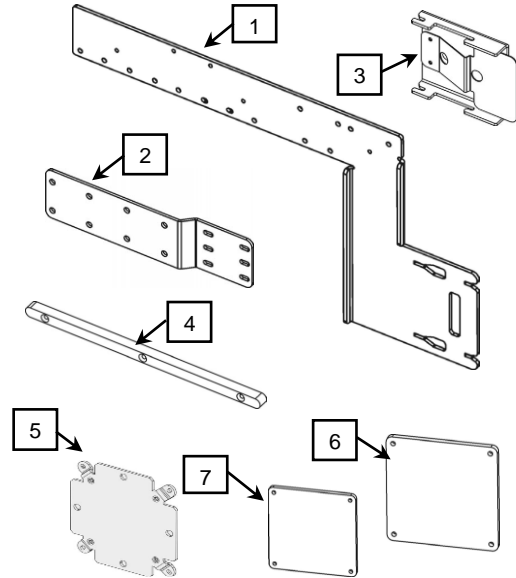

### Tools Required

- Phillips screwdriver (not provided).

### Installation Reference – Remote Bracket Mounting Holes

Mounting Holes are identified by shaded areas shown below:

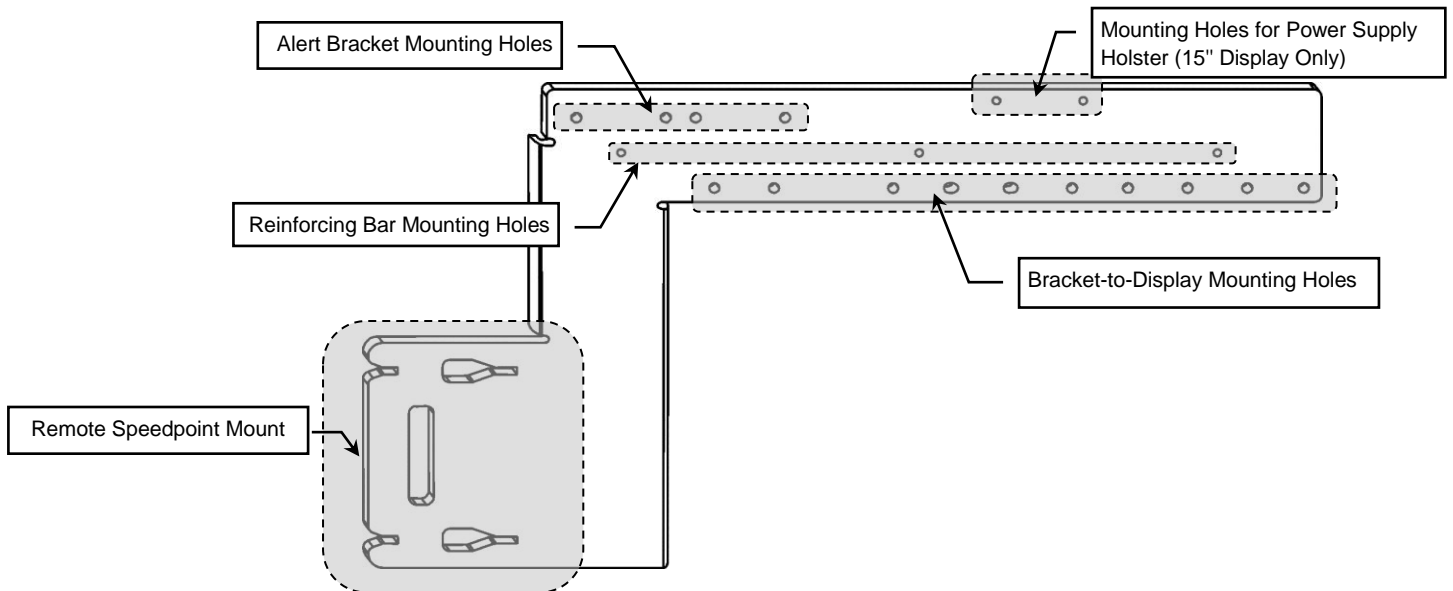

## Section 2.0 Attaching Remote Bracket and Mounting 15" (M8031B) Display

The following attachment procedures are for right-side mounting of both Remote and Alert devices on the M8031B display. The mounting holes shown in the following illustrations are typical. The actual application may require the use of different mounting holes.

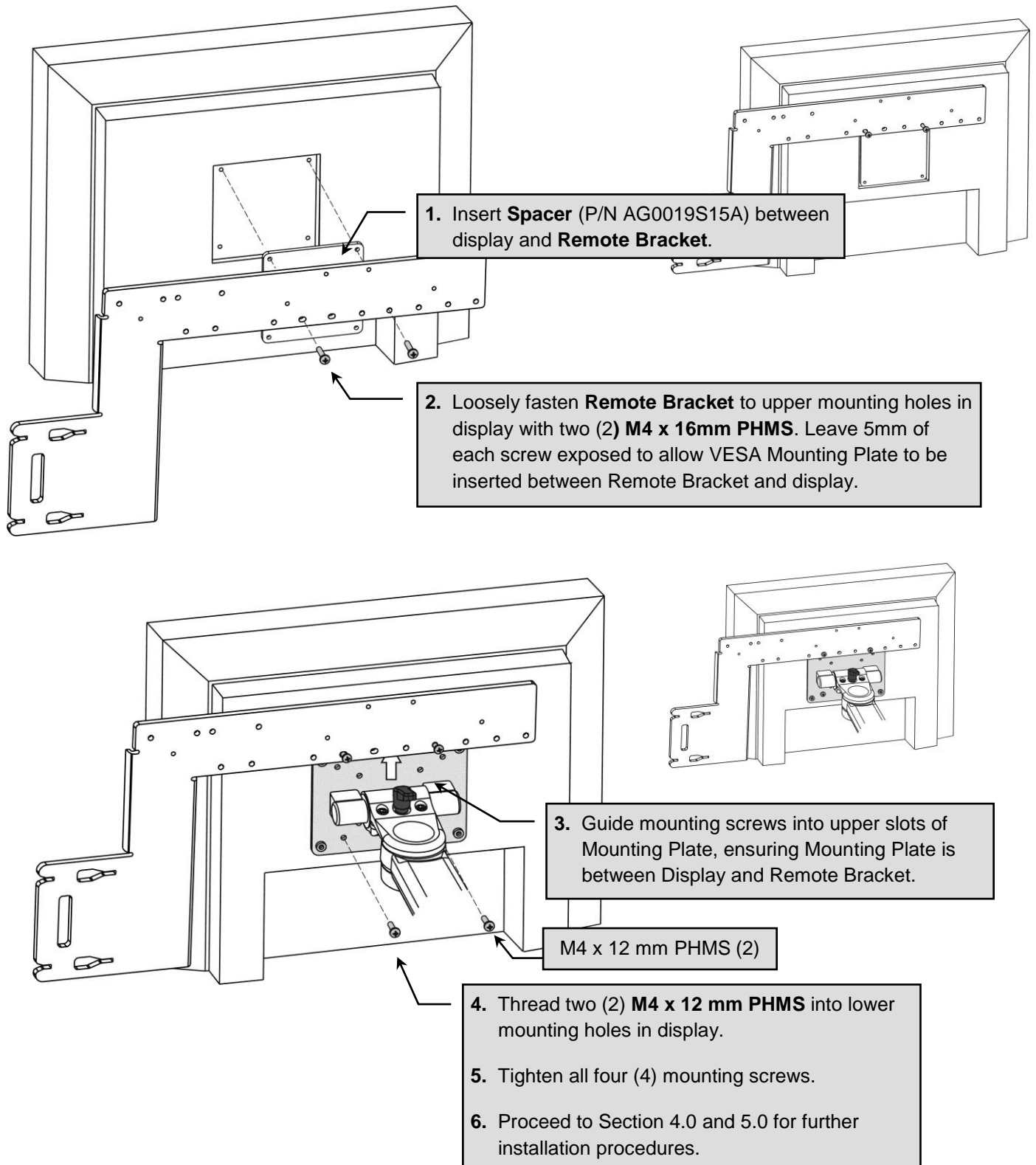

### Section 3.0 Attaching Remote Bracket and Mounting 19" (865299) Display

The following attachment procedures are for right-side mounting of both Remote and Alert devices on the 865299 display. The mounting holes shown in the following illustrations are typical. The actual application may require the use of different mounting holes.

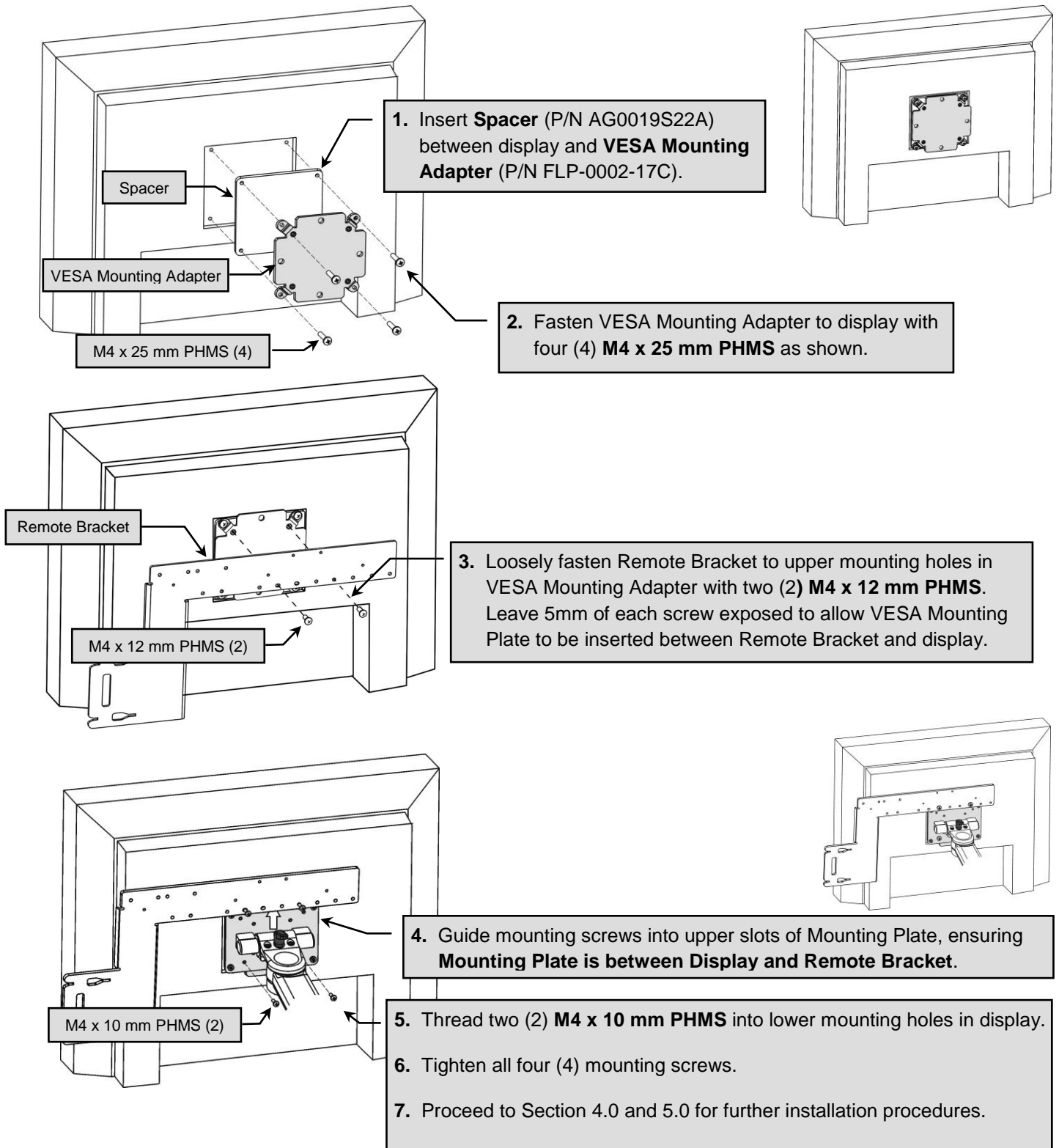

## Section 4.0 Attaching Alert Bracket and Reinforcing Bar to Remote Bracket

These procedures apply to both 15" and 19" displays.

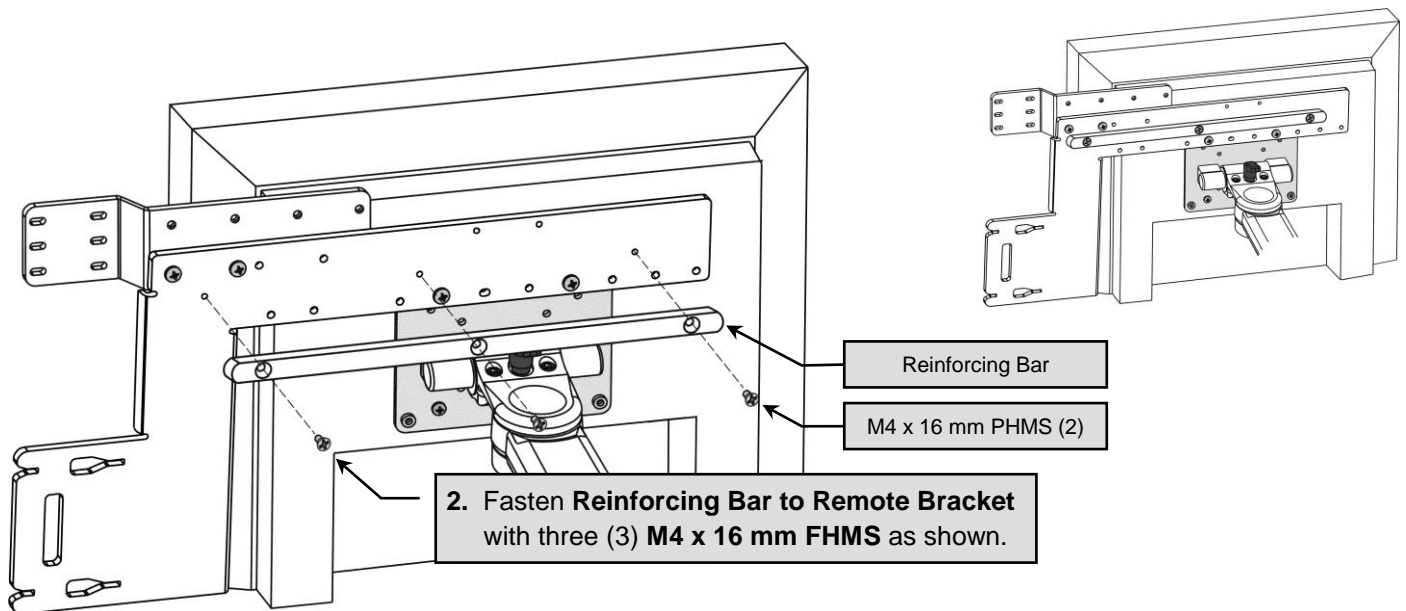
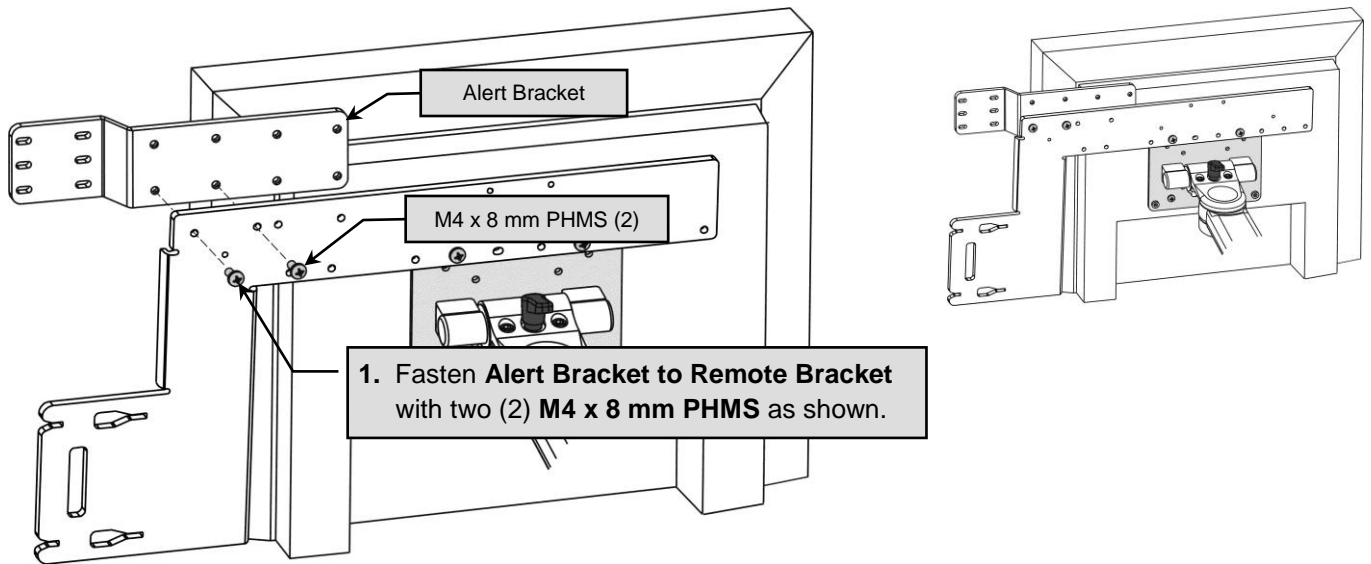

## Section 5.0 Mounting the Devices and Power Supply Holster

### 5.1 Mounting the External Alert Device

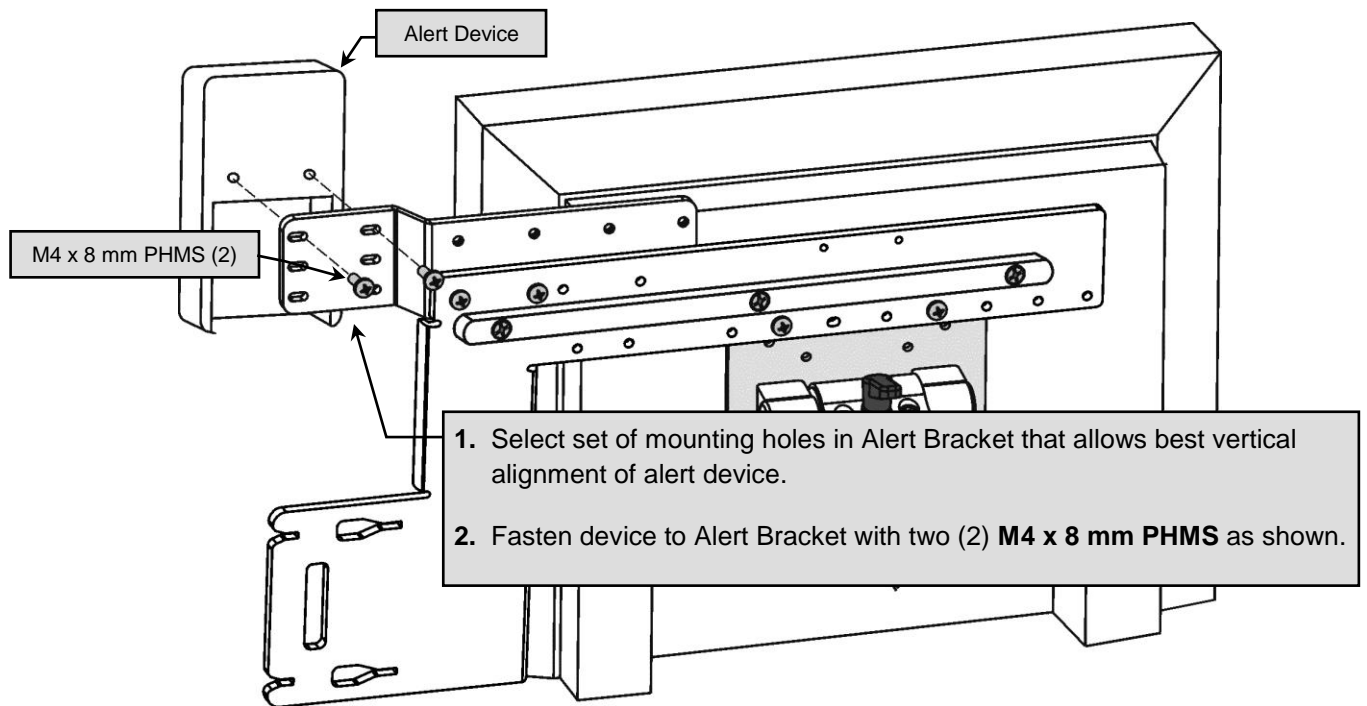

## 5.2 Mounting the Remote Speedpoint

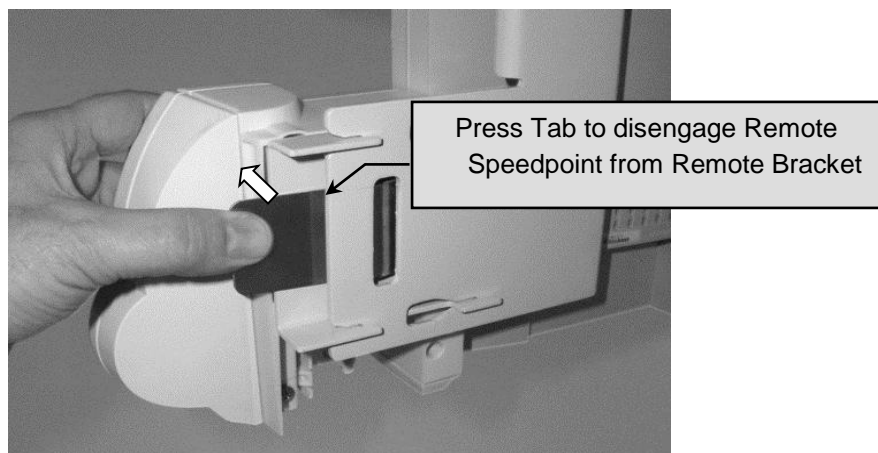
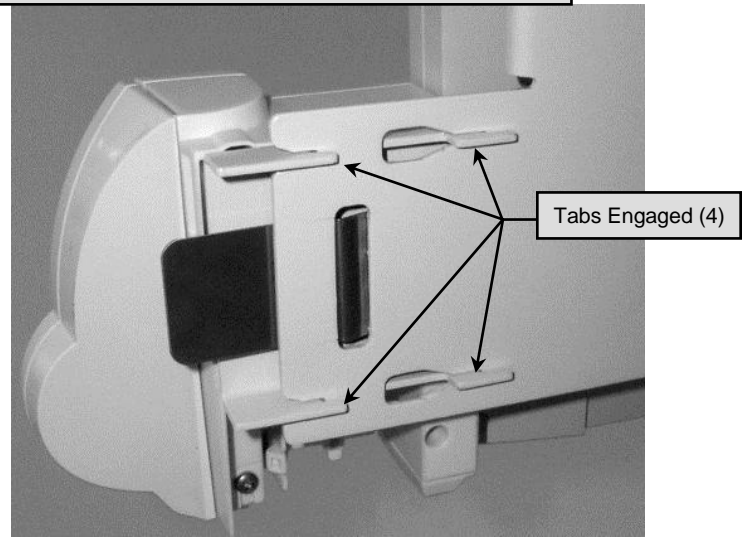
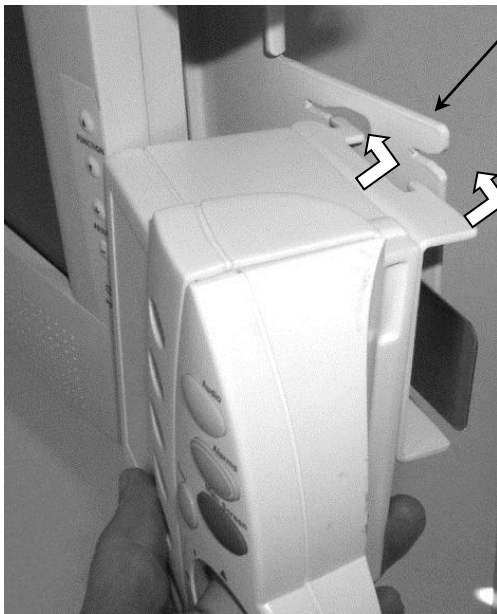
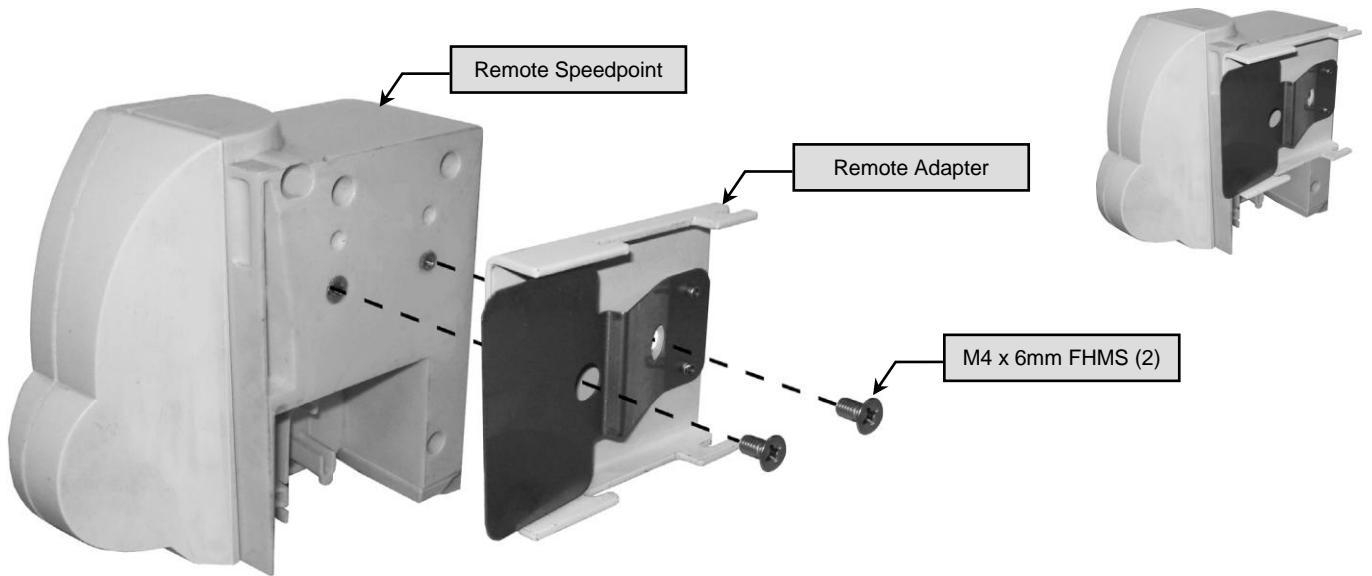

### 5.3 Attaching Power Supply Holster (not supplied) to Remote Bracket

**Installation Note:** The Power Supply Holster is not supplied with this kit.

1. Insert M4 x 20mm FHMS (2) from inside Holster, and assemble Nylon Spacers (2), and Retention Washers (2) on Screws as shown.

