

## GCX Mounting Assembly Installation Guide

### Roll Stand Laptop Tray with Sliding Mouse Extension

The purpose of these instructions is to:

1. Describe attachment of Laptop Tray to Roll Stand.
2. Describe attachment of Handle to Laptop Tray.

Note: The Handle is not included in this assembly, but can be purchased separately. For more information please contact a GCX Product Specialist at 800.228.2555 US/CAN.

#### Install Laptop Tray Bracket on VHRS Post

Line up the three (3) hole pattern on the Roll Stand with the three (3) hole pattern on the Laptop Tray Bracket and secure using the supplied #10-32 x 9/16" FHMS (3).

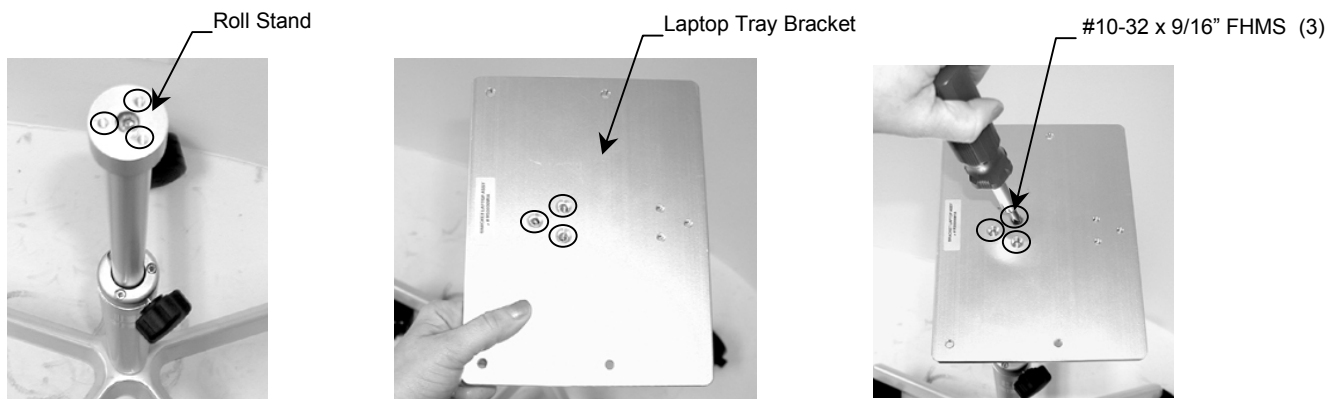

#### Install Laptop Tray

Line up the four (4) hole pattern on the Laptop Tray Bracket with the four (4) hole pattern on the bottom of the Laptop Tray and secure using the supplied #10-32 x 1/2" PHMS (4).

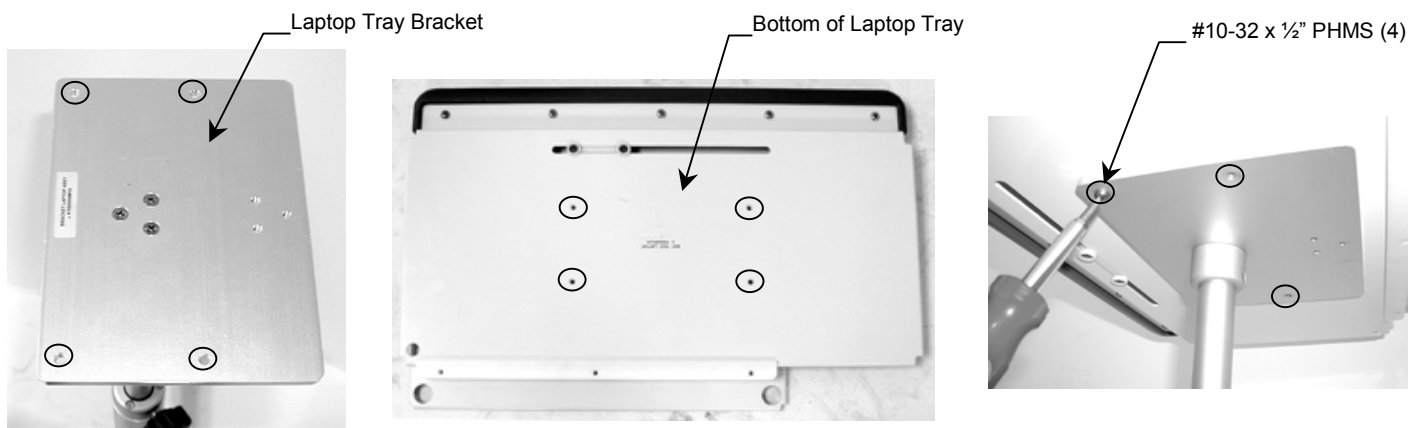

## **Optional Handle**

Line up the three (3) hole pattern on the Laptop Tray Bracket with the three (3) hole pattern on the Handle, and secure using the supplied #10-32 x 3/8" PHMS (3).

