

**Installation Guide**  
Philips X2/MP2/X3/MX100/MP5 Roll Stand

The purpose of this guide is to:

1. Describe assembly of Roll Stand (pages 2 – 3).
2. Describe attachment of Fixed Tilt Mounts (page 4).
3. Describe mounting MP5 on Roll Stand (page 5).
4. Describe mounting X2/MP2/X3/MX100 on Roll Stand (page 6).
5. Describe mounting of Tympanic Thermometer Base Station (page 8).
6. Describe cable management – X2/MP2/X3/MX100 only (page 9).



**WARNING:** USE OF THIS ROLL STAND FOR INSTRUMENTS OTHER THAN THOSE DESCRIBED IN THIS DOCUMENT MAY RESULT IN INJURY DUE TO TIPPING OF THE ROLL STAND. THE CUSTOMER SHOULD VERIFY THE STABILITY OF ANY DEVIATION FROM THE CONFIGURATIONS SHOWN.

**Parts Reference**

The following parts and hardware are included with this installation kit (hardware not shown):

Item #	Description	Qty
1	Post, 40"	1
2	Base, 21"	1
3	5/16-18 x 1" Hex Head Cap Screw (HHCS)	1
4	5/16 Flat Washer	1
5	5/16 Split Lock Washer	1
6	Utility Basket	1
7	Basket Clip	2
8	#8-32 x 7/8" Pan Head Machine Screw (PHMS)	2
9	#8-32 Hex Nut	2
10	Handle	1
11	#10-32 x 9/16" PHMS	4
12	Fixed Tilt Mount, MP5	1
13	Fixed Tilt Mount, X2/MP2/X3/MX100	1
14	M4 x 14mm PHMS	2
15	#10-32 x 3/4" Flat Head Machine Screw (FHMS)	3
16	Tympanic Thermometer Base and Power Supply Mount	2
17	M4 x 12mm PHMS	2
18	M6 x 10mm FHMS	3
19	M6 x 8mm PHMS	2
20	Cable Clip (not shown – see page 7)	2
21	Screw Cover, Adhesive-backed Lexan	1

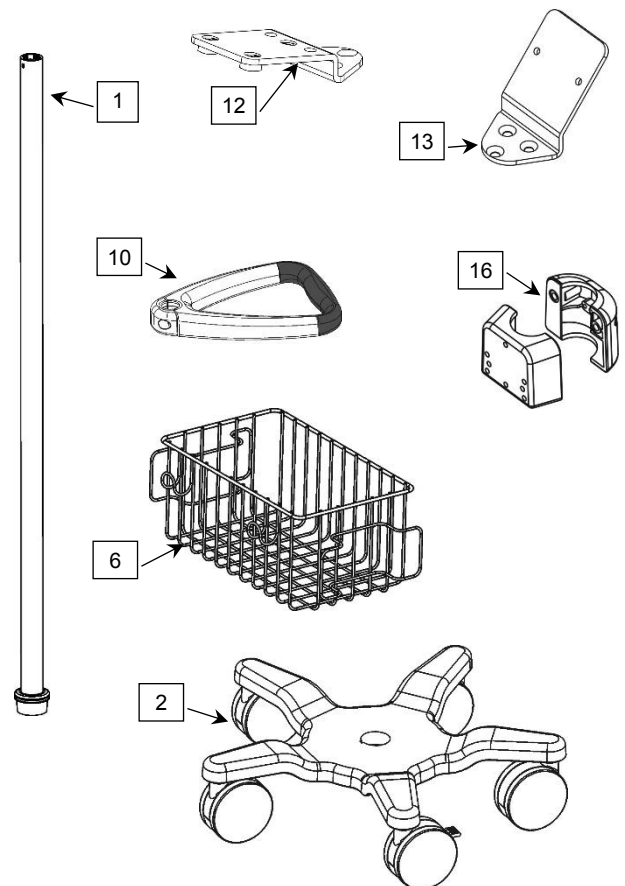

**Tools Required:** Phillips screwdriver (not provided), 1/2" [13mm] wrench (not provided).

## Assembling the Roll Stand

1. Insert bottom end of Post in center of Base and lay assembly on its side for access to bottom of base (not shown).
2. Using a 1/2" [13mm] wrench, fasten Post to Base with one (1) 5/16-18 x 1" HHCS, with 5/16 split lock washer, and 5/16" flat washer as shown below. Return Roll Stand to upright position.

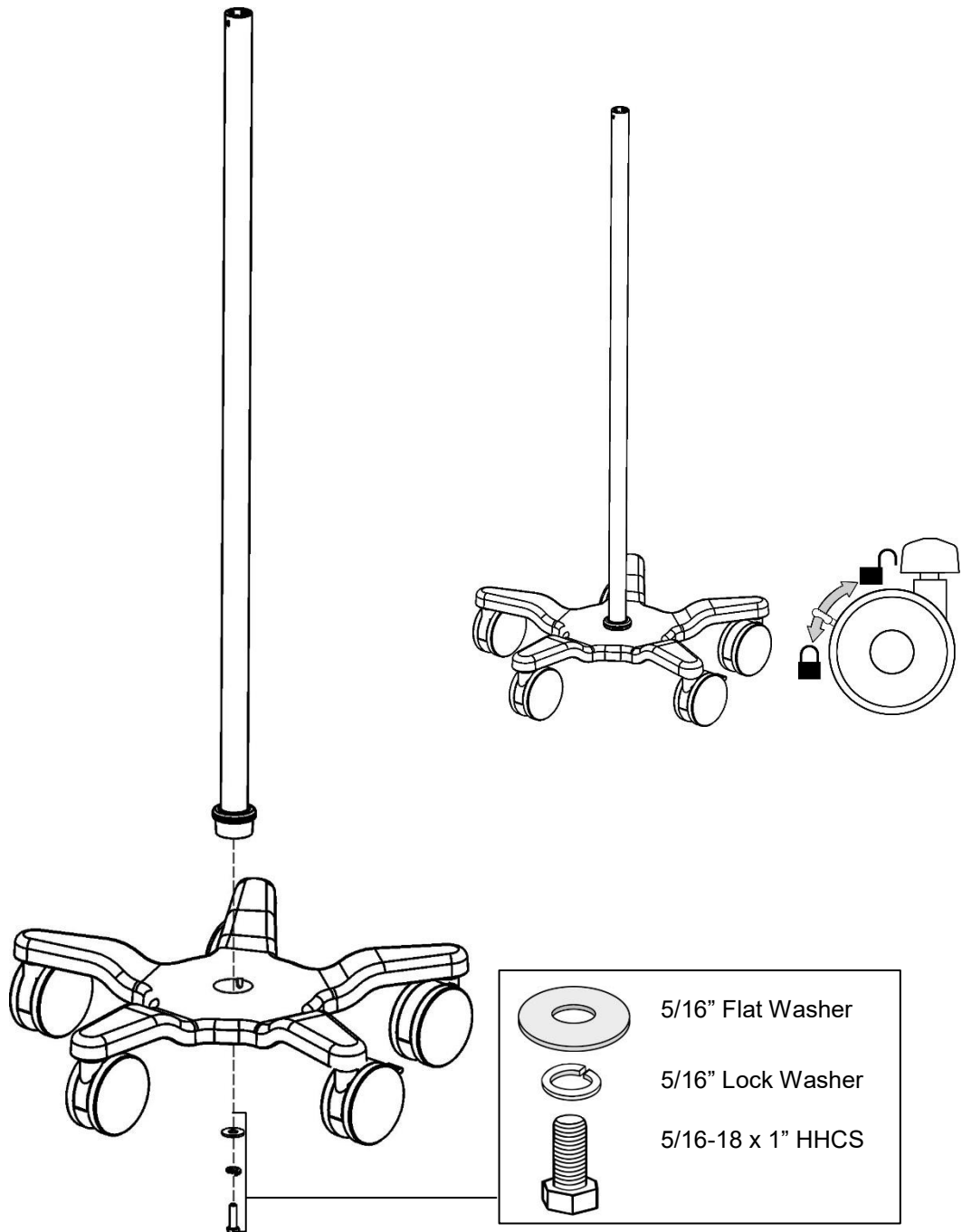

## Attaching Utility Basket and Handle to Roll Stand Post

1. Attach two (2) Basket Clips to Utility Basket as shown below left. Insert two (2) #8-32 x 7/8" PHMS and #8-32 hex nuts in Basket Clips but do not tighten.
2. Slide Basket Clips over top end of Roll Stand Post (below right) and move Basket to mounting position. Do not tighten screws at this time. Basket may require re-alignment after the Fixed Tilt Mount is attached.

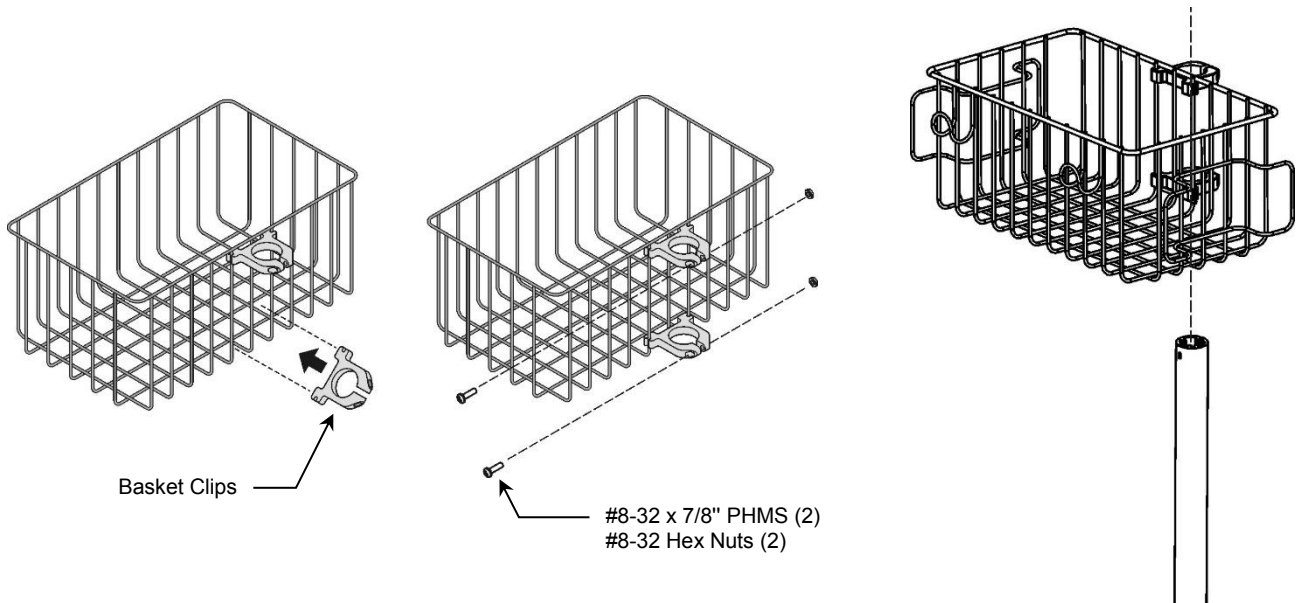

3. Position the Handle below the top of the Roll Stand Post opposite the Basket. Fasten Handle to Post with two (2) #10-32 x 9/16" PHMS as shown, but do not tighten at this time. Handle may require re-alignment after the Fixed Tilt Mount is attached.

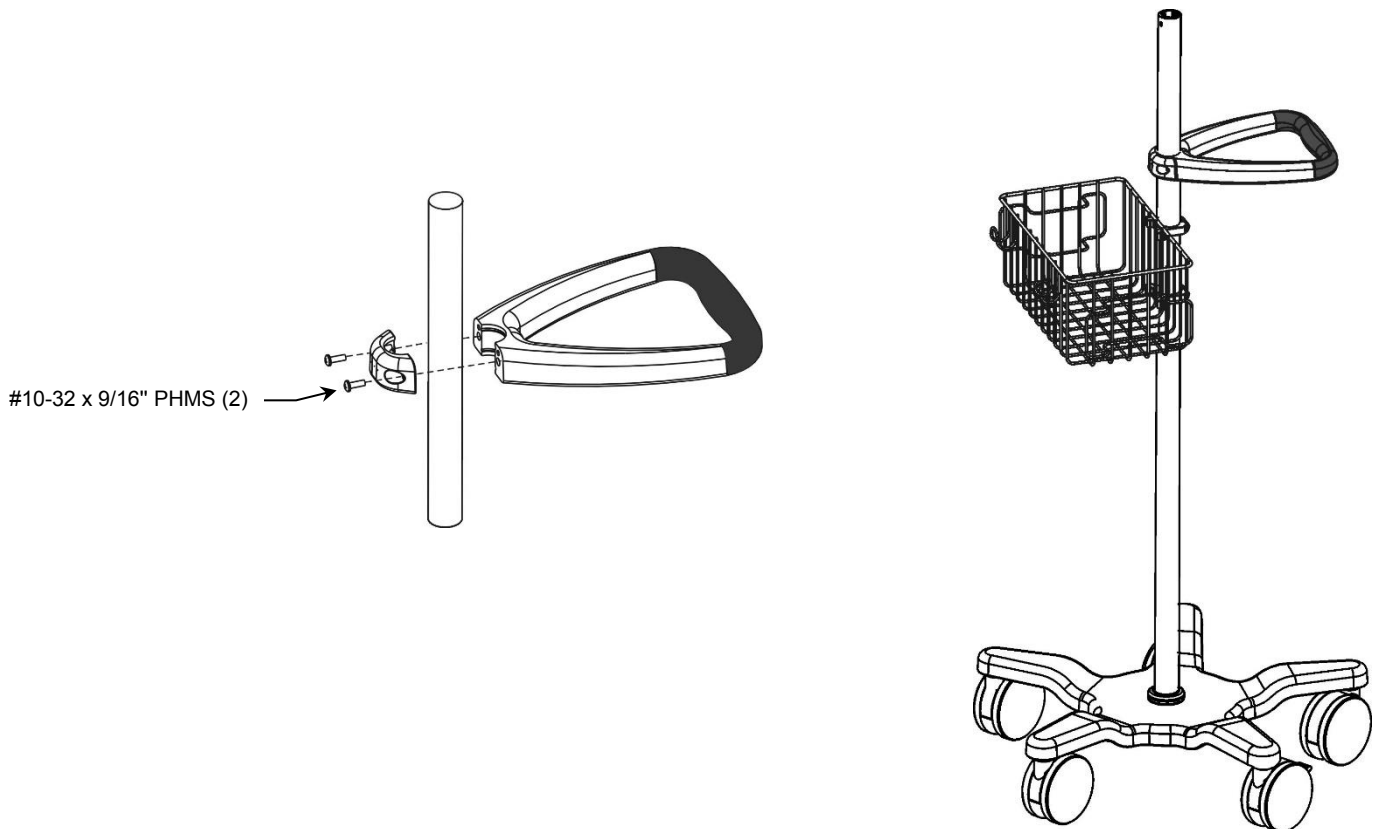

## Attaching Fixed Tilt Mount to Roll Stand Post

1. Align three (3) mounting holes in Fixed Tilt Mount with corresponding mounting holes in top of Post and fasten Mount to Post with three (3) #10 x 3/4" FHMS as shown below. **Installation Note:** Fixed Tilt Mount must be oriented toward the intended front of the roll stand as shown below.

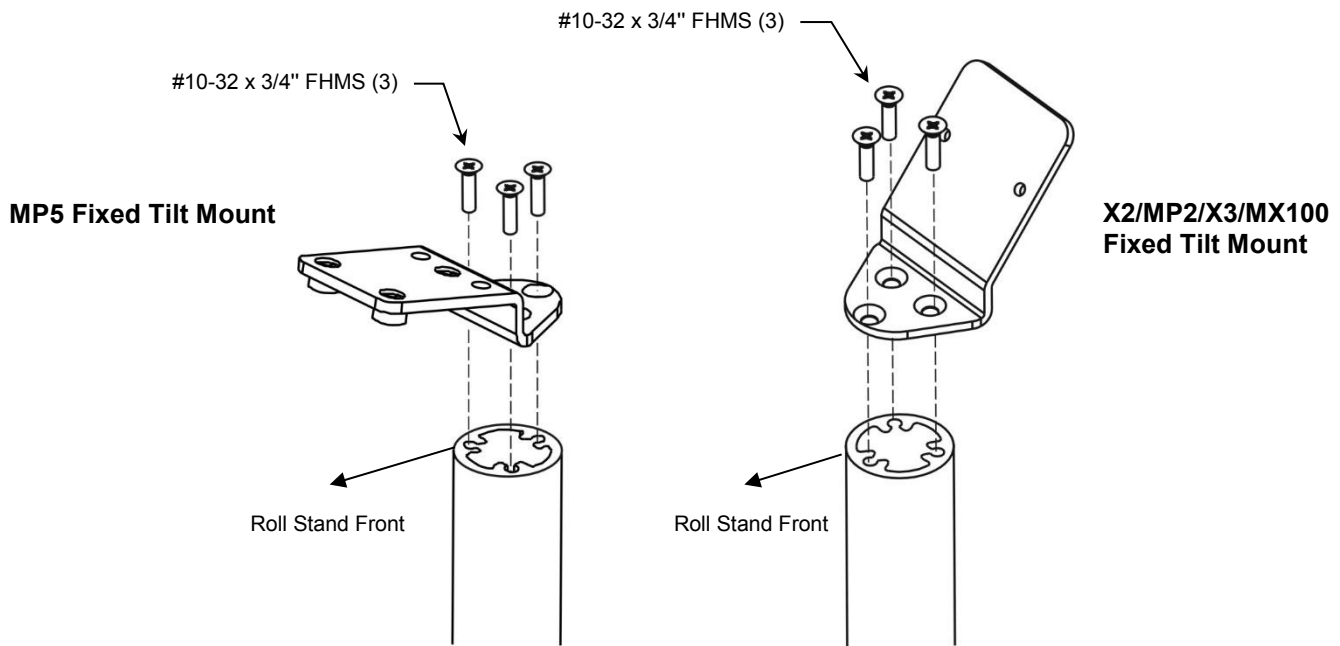

2. Remove backing from Lexan Screw Cover and place on top of screw heads as shown below. Procedure is same for X3/MP2 Mount (shown) or MP5 Mount.

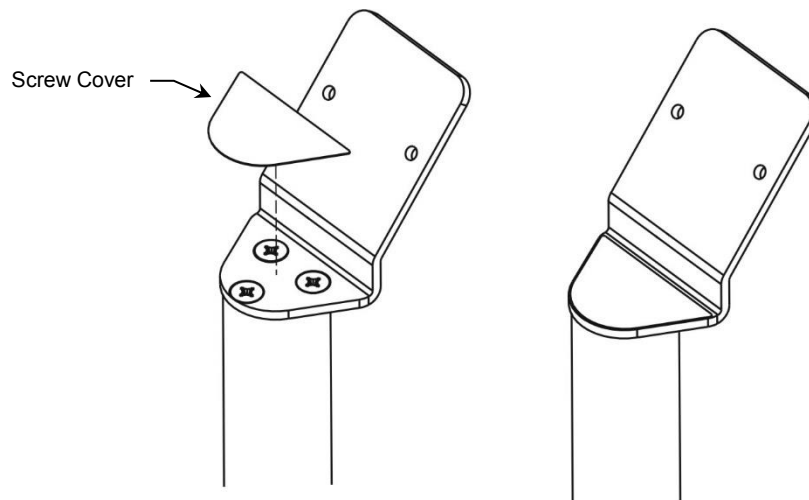

3. Not shown. Align Basket and Handle with the Fixed Tilt Mount orientation and tighten mounting screws as required to secure Basket and Handle on the Post.

## Mounting MP5 on the Roll Stand

The MP5 monitor will be equipped with one of two different mounting interfaces on the bottom of the monitor. The type of interface determines which mounting procedure to follow on this page.

### Mounting MP5 on Philips Table Mount (Requires Philips-supplied Table Mount)

1. Fasten the Philips-supplied table mount to the Mounting Adapter with three (3) M6 x 10mm FHMS as shown below. Mount the monitor in accordance with Philips mounting instructions.

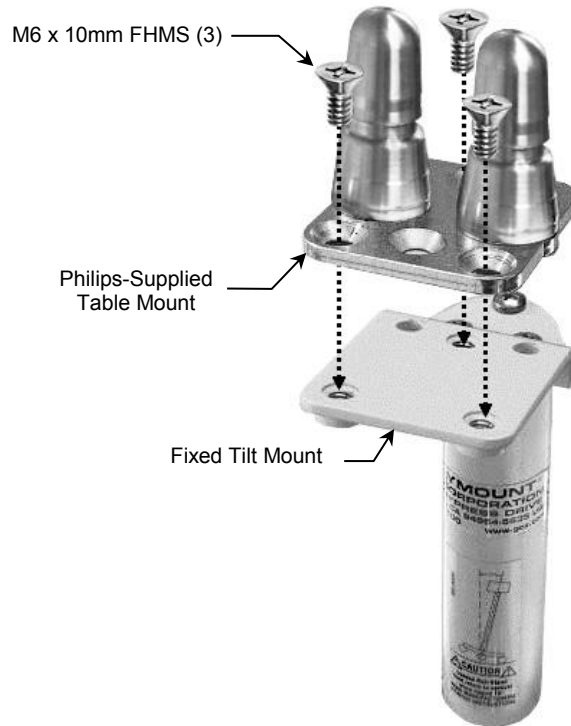

### Mounting MP5 with Fixed Tilt Mount

1. Using a Phillips screwdriver, fasten monitor to Fixed Tilt Mount with two (2) M6 x 8 mm PHMS as shown.

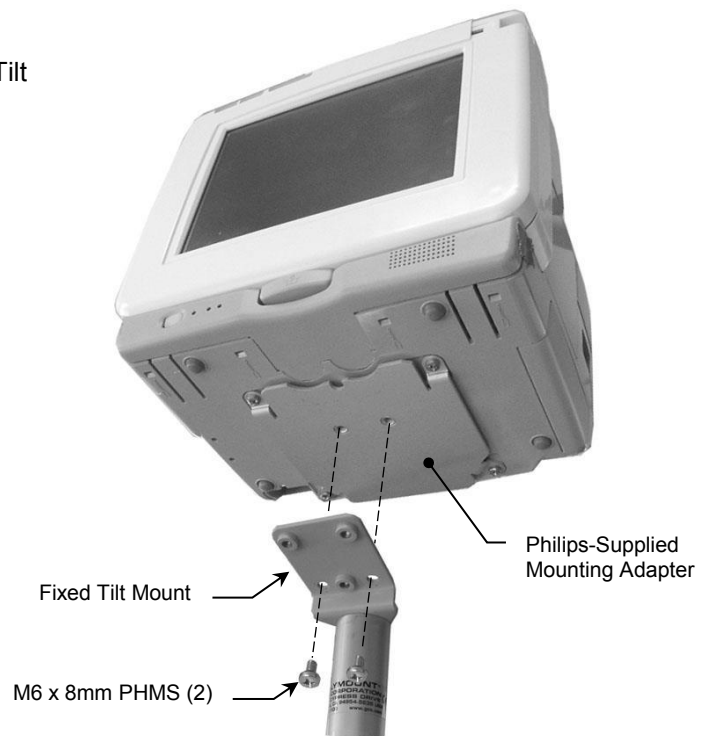

## Mounting X2/MP2/X3/MX100

### Attaching IntelliVue Dock (supplied by Philips) to Fixed Tilt Mount

1. Fasten IntelliVue Dock to the Fixed Tilt Mount with two (2) M4 x 10 mm PHMS as shown below. Mount monitor on IntelliVue Dock according to manufacturer's instructions.

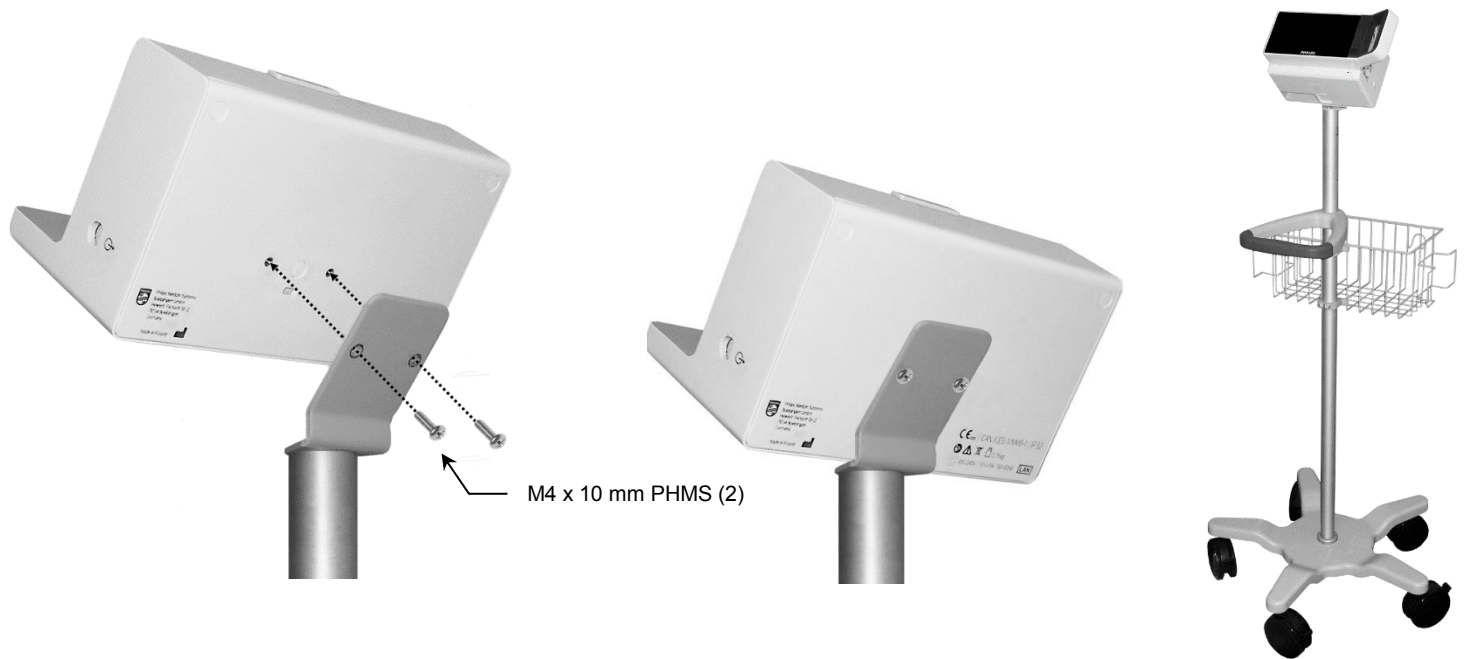

### Attaching Mounting Plate (supplied by Philips) to Fixed Tilt Mount

1. Fasten mounting plate to the Fixed Tilt Mount with two (2) M4 x 14 mm PHMS as shown below. Mount monitor on mounting plate according to manufacturer's instructions.

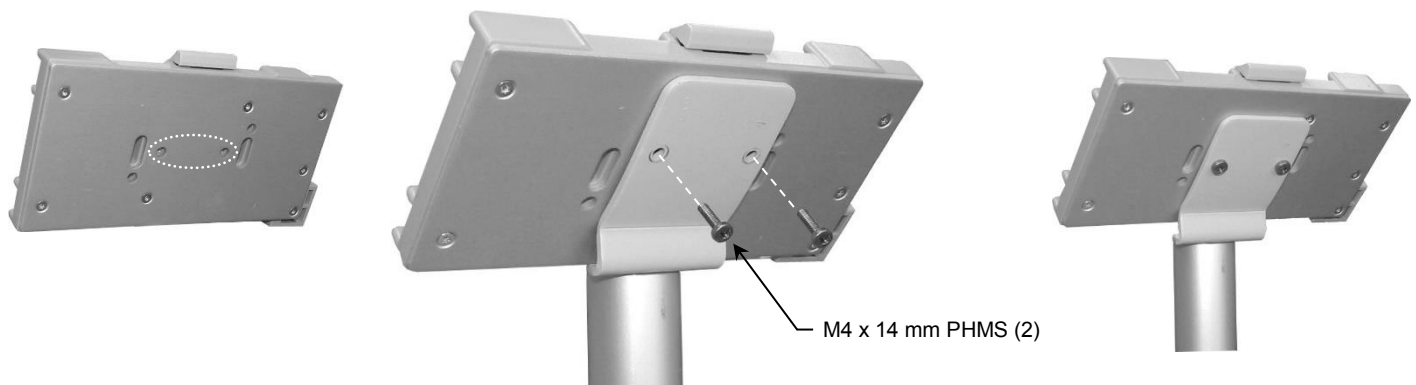

## Mounting the Power Supply

**Installation Note:** If using the IntelliVue Dock, no power supply is required.

1. Fasten Clamping Block to power supply with two (2) M4 x 12 mm PHMS as shown below.

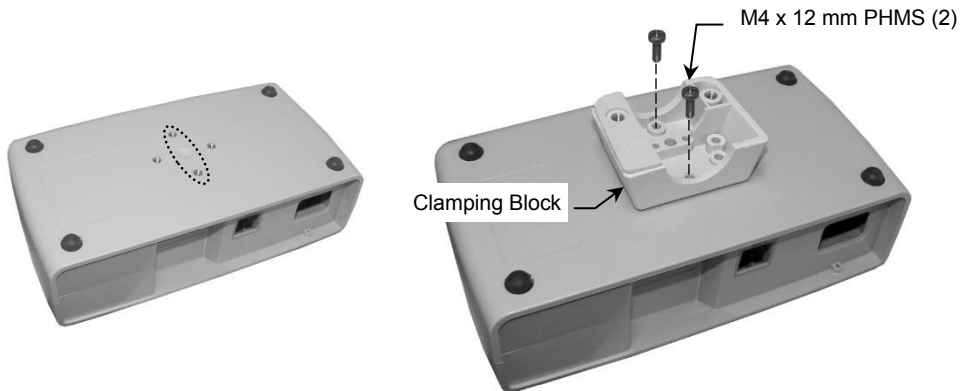

2. Fasten power supply to Post with rear Clamping Block and two (2) #10-32 x 9/16" PHMS as shown below.

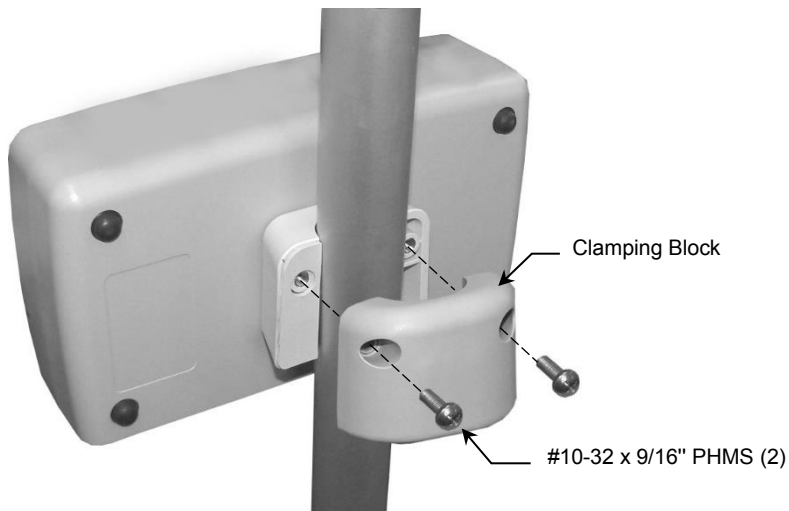

## Mounting the Tympanic Thermometer Base Station

**Installation Note:** Install and route Base Station cables prior to fastening Clamping Block to Base Station.



Front Clamping Block



Back Clamping Block

1. Using a Phillips screwdriver, fasten the front Clamping Block to Base Station with two (2) M4 x 12 mm PHMS as shown below.

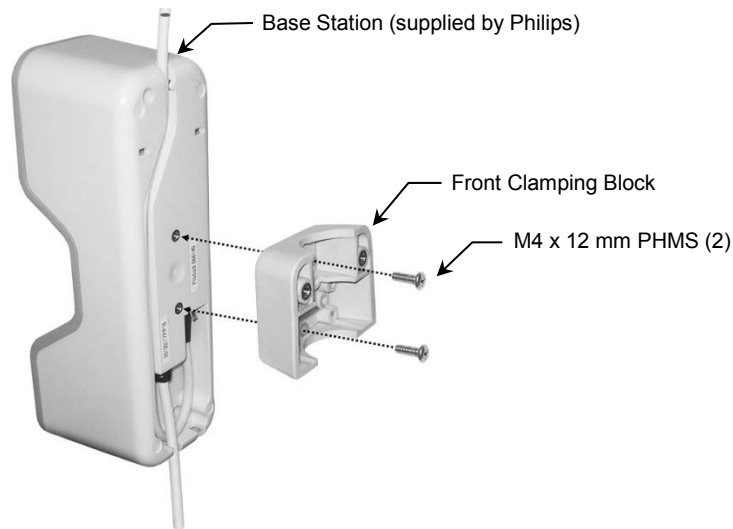

2. Using a Phillips screwdriver, secure the Base Station mounting assembly to post with the back Clamping Block and two (2) 10-32 x 9/16" PHMS as shown below.

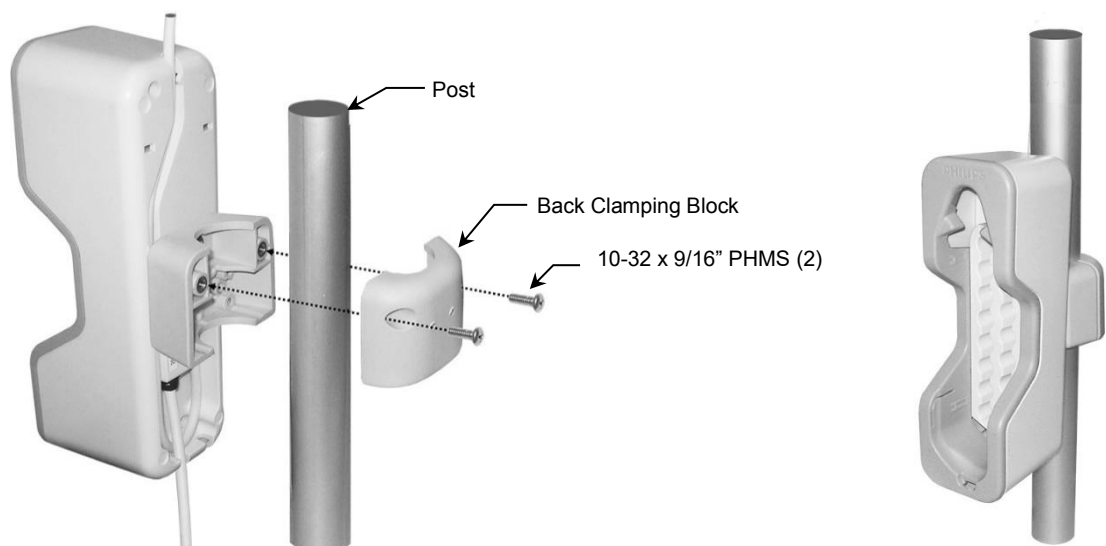



## Cable Management

Two (2) Cable Clips are provided for managing cables along Roll Stand Post. Place loose cables inside Clip and slide Clip onto Post as shown.

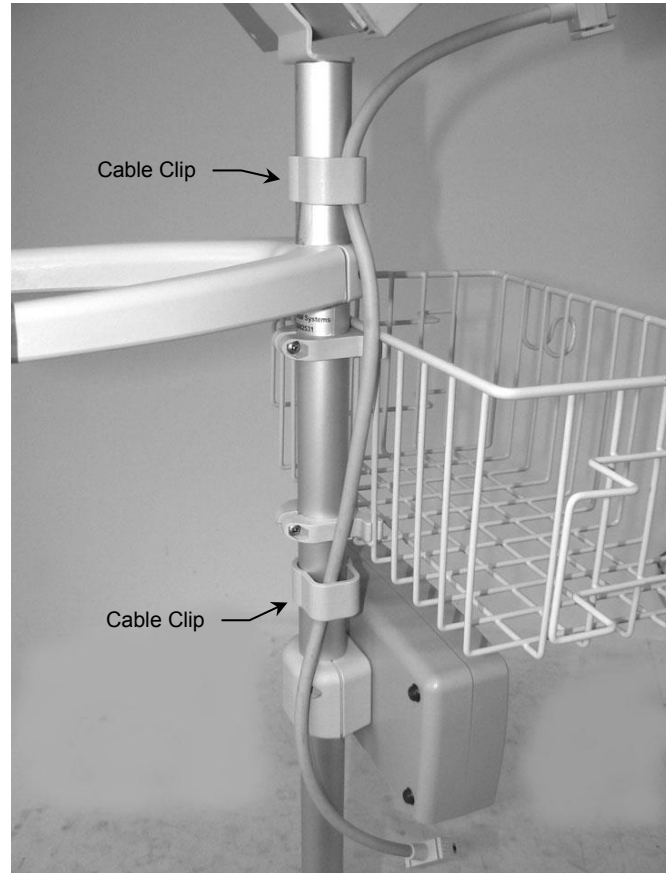
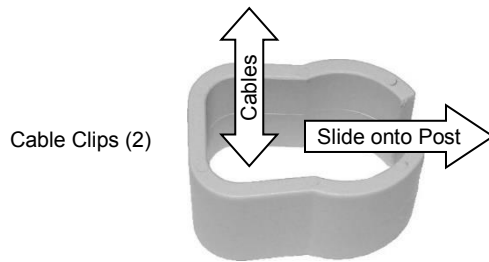

## Routine Maintenance

Periodically check all mounting hardware. Tighten as necessary for optimal operation and safety.

## Cleaning the Mounting Assembly

**CAUTION:** GCX makes no claims regarding the efficacy of the listed chemicals or processes as a means for controlling infection. Consult your hospital's infection control officer or epidemiologist. To clean or sterilize mounted instruments or accessory equipment, refer to the specific instructions delivered with those products.

1. The mounting assembly may be cleaned with most mild, non-abrasive solutions commonly used in the hospital environment (e.g. diluted bleach, ammonia, or alcohol solutions).
2. The surface finish will be permanently damaged by strong chemicals and solvents such as acetone and trichloroethylene.
3. Do not use steel wool or other abrasive material to clean the mounting assembly.
4. Damage caused by the use of unapproved substances or processes will not be covered by warranty. We recommend that you test any cleaning solution on a small area of the mounting assembly that is not visible to verify compatibility.
5. Never submerge or allow liquids to enter the mounting assembly. Wipe any cleaning agents off the mounting assembly immediately, using a water-dampened cloth. Dry all mounting assemblies thoroughly after cleaning.