

## Installation Guide

### GE Healthcare Solar 8000 Dual-Channel Roll Stand Kit

*The purpose of this guide is to describe assembly of the Roll Stand.*

#### Parts Reference

The following parts and hardware will be used in this installation procedure. Individual components are shown on pages 2 – 4.

Item #	Description	Qty
1	Dual Channel Roll Stand Post, 46"	1
2	Roll Stand Base with 10 lb. Counterweight	1
3	1/4-20 x 3/4" Socket Head Cap Screw (SHCS)	6
4	Handle, Roll Stand	1
5	Display Mount Assembly	1
6	Utility Basket	1
7	Tram-rac Mount	1
8	#6-32 x 1/2" Pan Head Machine Screw (PHMS)	4
9	Base Unit Mount	1
10	PRN-50 Mounting Adapter	1
11	M4 x 10mm PHMS	4
12	PRN-50 Wall Mount	1
13	#8-32 x 5/16" PHMS	4
14	Power Supply Bracket	1
15	Adjustable Stop	1
16	Display Handle	1
17	Spacer, .50" x .171" x 3/16" Nylon	4
18	M4 x 14mm PHMS	4
19	Channel Cover, 16" L x 2" W	4
20	Channel Cover, 16" L x 1" W	4
21	3/16" Hex Wrench	1
22	1/8" Hex Wrench	1
23	9/64" Hex Wrench	1

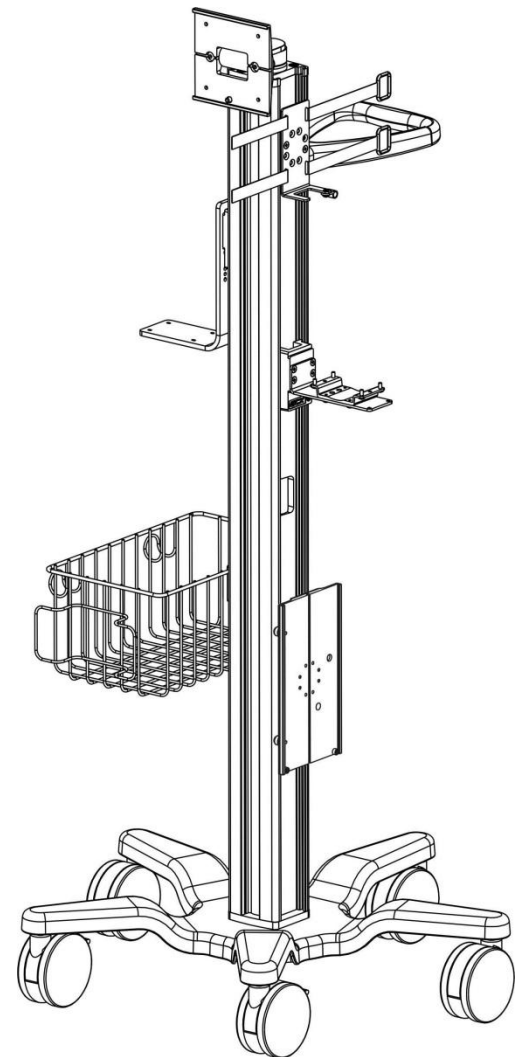

**Tools Required:** 3/16", 1/8", and 9/64" hex wrenches (provided); Phillips screwdriver (not provided).

## Assembling the Roll Stand

1. Insert the Dual Channel Post in the Base and lay the assembly on its side for access to the bottom of the Base.
2. Using the 3/16" hex wrench provided, fasten Post to Base with two (2) 1/4-20 x 3/4" SHCS.

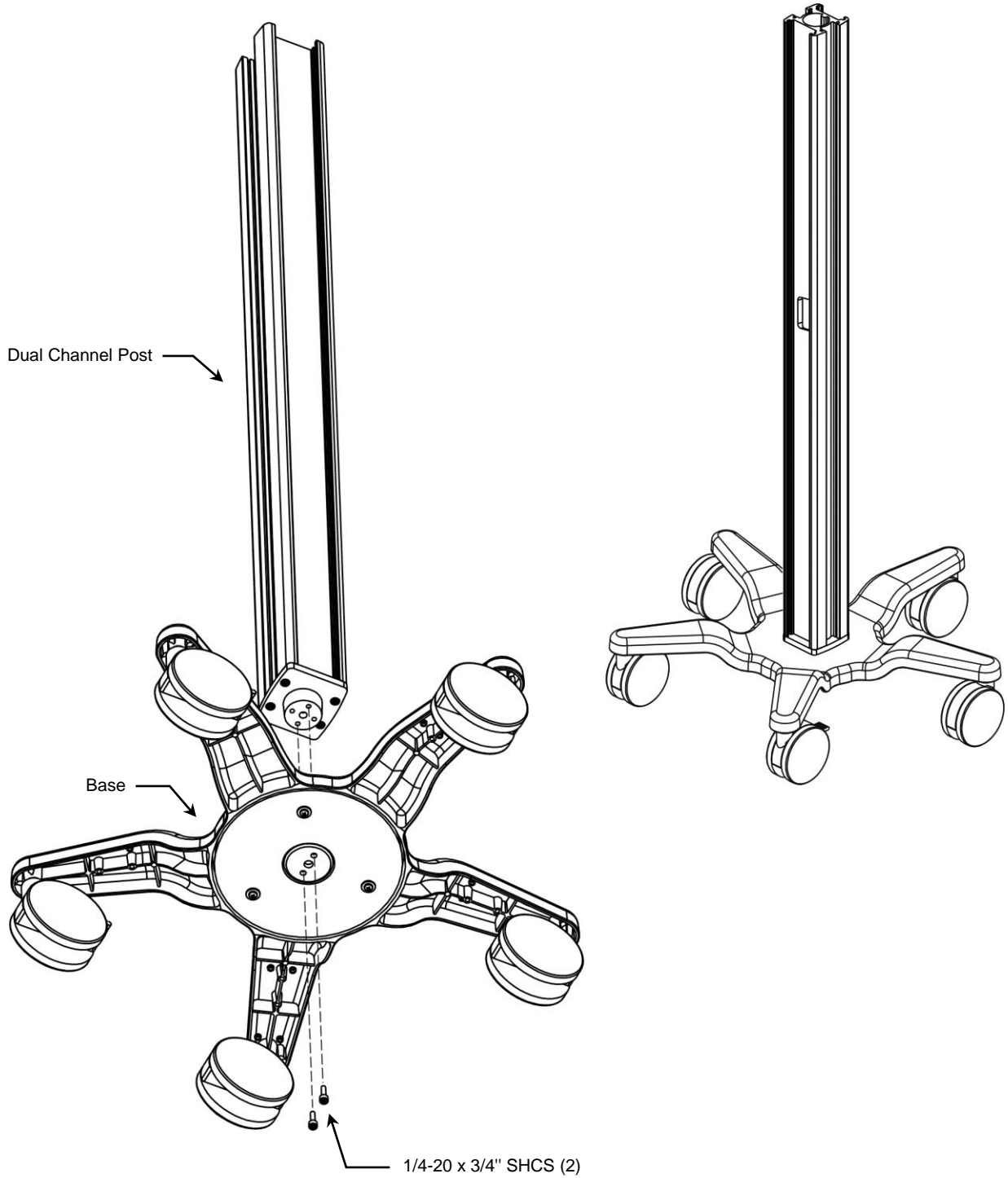

## Installing Components and Accessories on the Dual Channel Post

Most channel-mounted components are mounted by inserting the Channel-Slide in the top of the Channel, moving the assembly to the desired mounting position and tightening one or more set screws. If set screws are not provided, an Adjustable Stop (provided) must be installed to prevent the mounting assembly from sliding down the Channel (see callout #8 below).

Numbered callouts indicate the order of component installation on the Dual Channel Post. White arrows indicate typical position of installed component. **Installation Note:** The Handle must be installed in a 1" Channel before the Display Mount Assembly is fastened to the top of the Post.

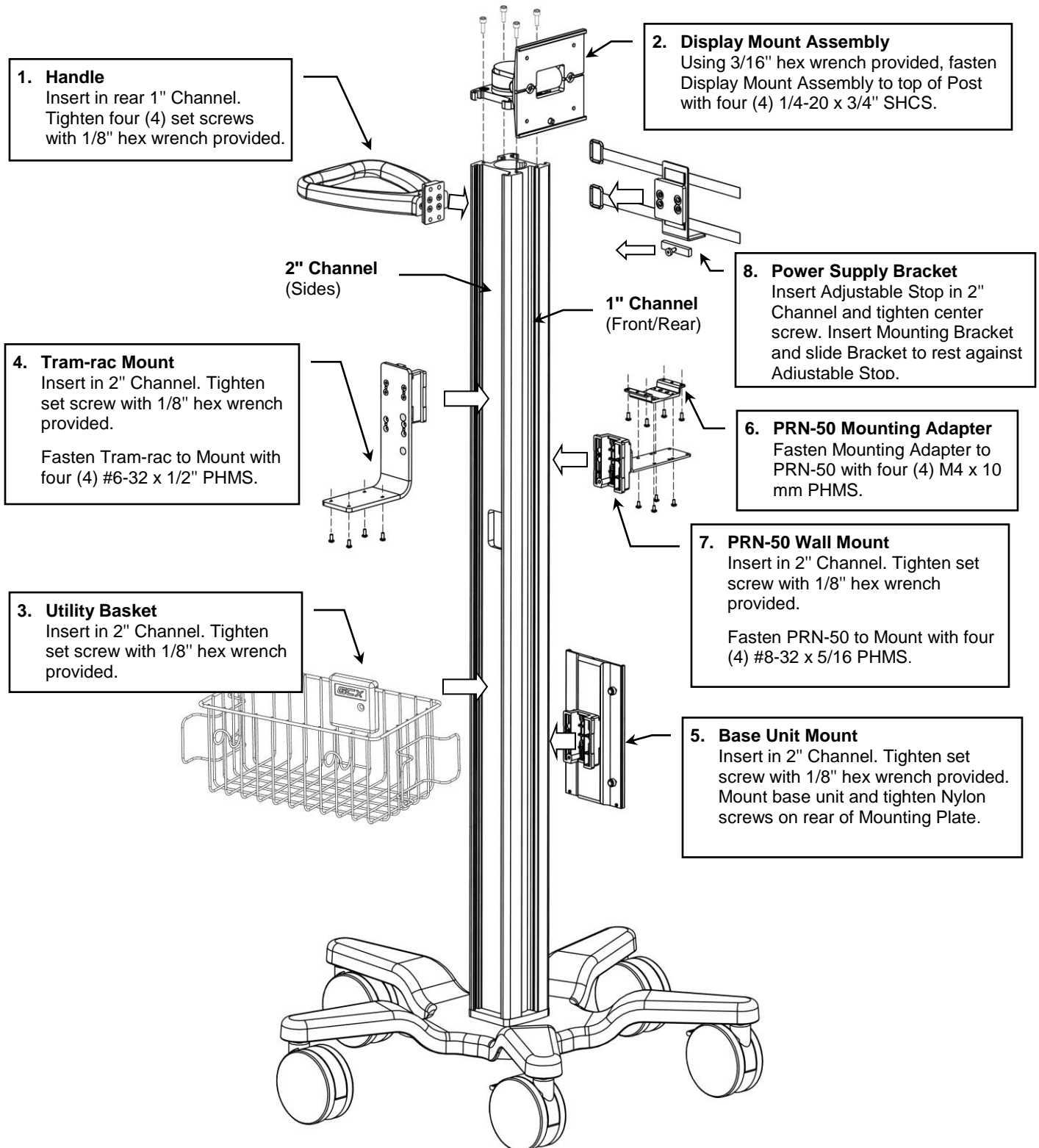

## Mounting the Handle on the Flat Panel Display

Refer to illustrations below for this procedure.

1. Remove the existing Mounting Adapter from the rear of the display by unscrewing four (4) M4 screws. These screws will not be used again. Mounting Adapter will be re-installed in step 5.
2. Align Handle assembly with mounting holes in rear of display.
3. Place one (1) Nylon Spacer (.50" x .171 x 3/16") over each of the four (4) mounting holes in the Handle.
4. Place Mounting Adapter over Nylon spacers and fasten Adapter to display with four (4) M4 x 14mm PHMS.

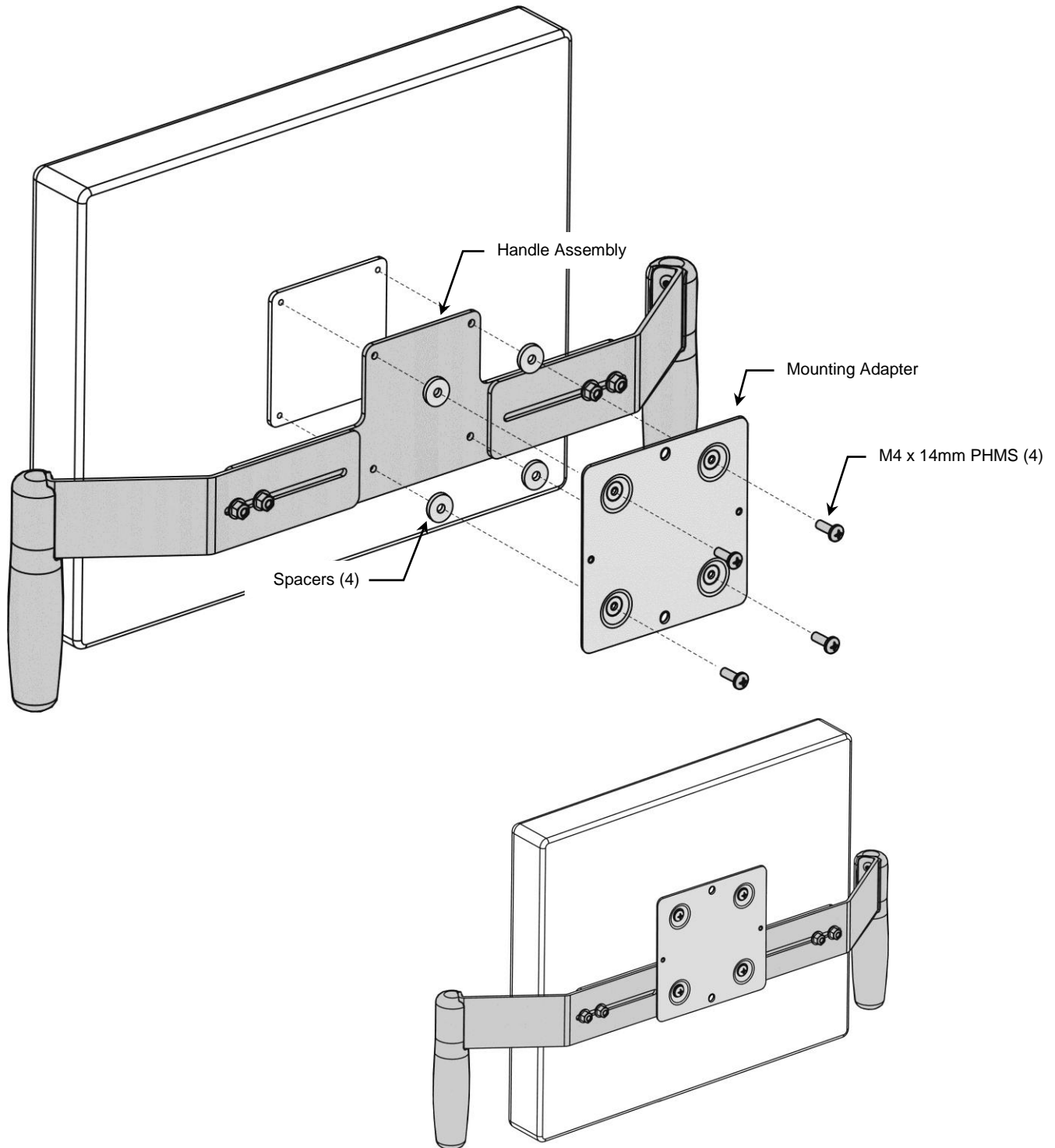

## Mounting the Display on the Roll Stand

1. Slide Mounting Adapter (rear of display) onto Mounting Plate until Adapter makes contact with Plunger. Pull and hold Plunger while sliding Adapter over Plunger. Release Plunger and continue sliding display until Plunger snaps into clearance hole. Tighten Nylon screws on rear of Mounting Plate.

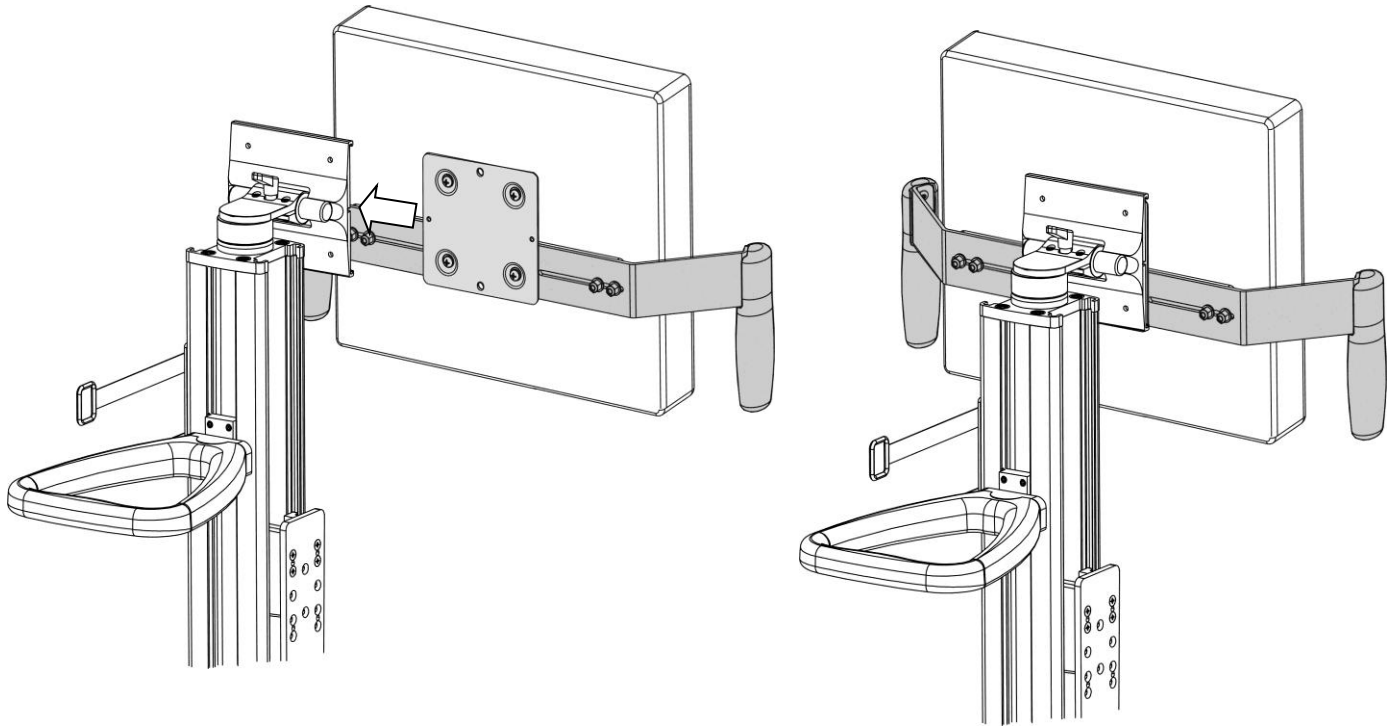

## Adjusting Tilt and Tilt Tension

1. For minor adjustments, loosen the Tilt Adjustment Lever, grasp the Display Handles and tilt to the desired angle. Tighten the Tilt Adjustment Lever.
2. To adjust overall tilting tension, equally tighten or loosen the two (2) socket head Tilt Tension Screws with the 9/64" hex key provided.

**Note:** The Tilt Adjustment Lever is a multi-position clamping lever that operates by lifting, rotating, and releasing the handle.

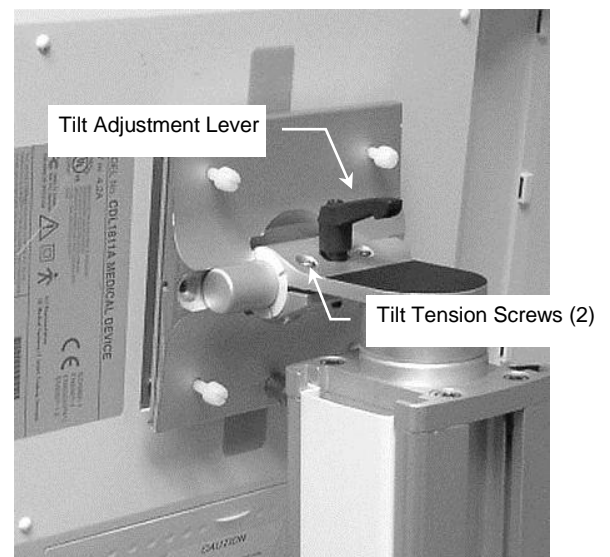
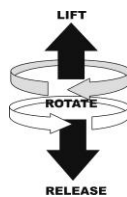

## Cable Management

Cables may be routed behind Channel Covers (not shown) and Channel Slides. A pass-through hole is also provided for routing cables from one side of the Post to the other.

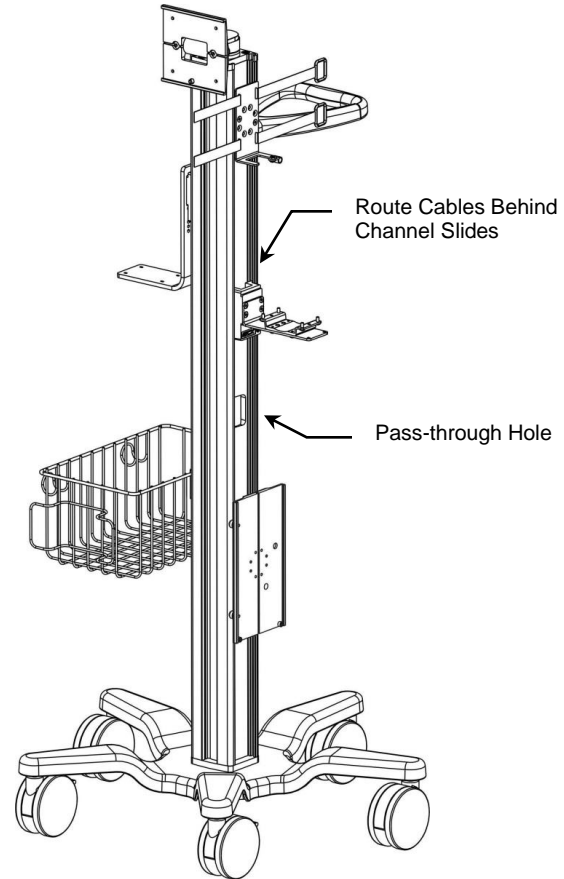

## Routine Maintenance

Periodically check all mounting hardware. Tighten as necessary for optimal operation.

## Cleaning the Mounting Assembly

1. The mounting assembly may be cleaned with most mild, non-abrasive solutions commonly used in the hospital environment (e.g. diluted bleach, ammonia, or alcohol solutions).
2. The surface finish will be permanently damaged by strong chemicals and solvents such as acetone and trichloroethylene.
3. Do not use steel wool or other abrasive material to clean the mounting assembly.
4. Damage caused by the use of unapproved substances or processes will not be covered by warranty. We recommend that you test any cleaning solution on a small area of the mounting assembly that is not visible to verify compatibility.
5. Never submerge the roll stand or allow liquids to enter the mounting assemblies. Wipe any cleaning agents off the mounting assembly immediately, using a water-dampened cloth. Dry all mounting assemblies thoroughly after cleaning.

**CAUTION:** GCX makes no claims regarding the efficacy of the listed chemicals or processes as a means for controlling infection. Consult your hospital's infection control officer or epidemiologist. To clean or sterilize mounted instruments or accessory equipment, refer to the specific instructions delivered with those products.