

Installation Guide

Philips Intellivue MP5/20/30/40/50/60/70, MX400/450/500/550/600/700/800
Top Shelf Mounting Kit for Dräger Apollo Anesthesia Machine

The purpose of this guide is to describe installation of mounting assemblies on the anesthesia machine.



WARNING: USE OF MOUNTING HARDWARE AND MONITORING COMPONENTS OTHER THAN THOSE DESCRIBED IN THIS DOCUMENT MAY RESULT IN SERIOUS INJURY DUE TO TIPPING OF THE ANESTHESIA MACHINE.

WARNING: ALL DEVICES AND MOUNTING EQUIPMENT SHOULD BE POSITIONED INWARD, CLOSE TO THE ANESTHESIA MACHINE, DURING TRANSPORT.

Installer: *When installation is completed, provide these instructions and all related documentation to the end user for future reference.*

Mounts for Philips Intellivue MP5/20/30/40/50/60/70, MX400/450/500/550/600/700/800

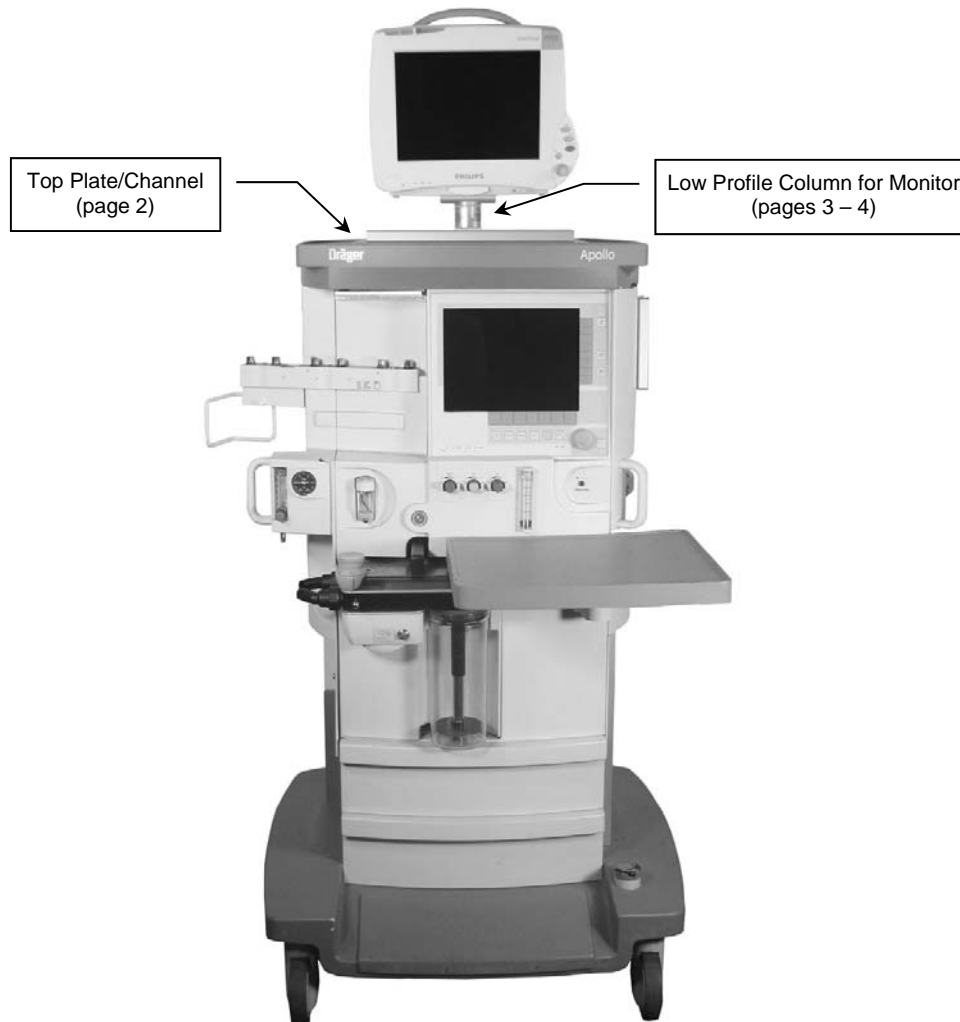

Attaching Top Plate/Channel to Top of Apollo

The following parts and hardware are included in this installation kit (hardware not shown):

Item #	Description	Qty
1	Top Plate/Channel Assembly	1
2	M4 x 10 mm Flat Head Machine Screw (FHMS)	4



Tools required: Phillips screwdriver (not provided)

Installing the Top Plate/Channel

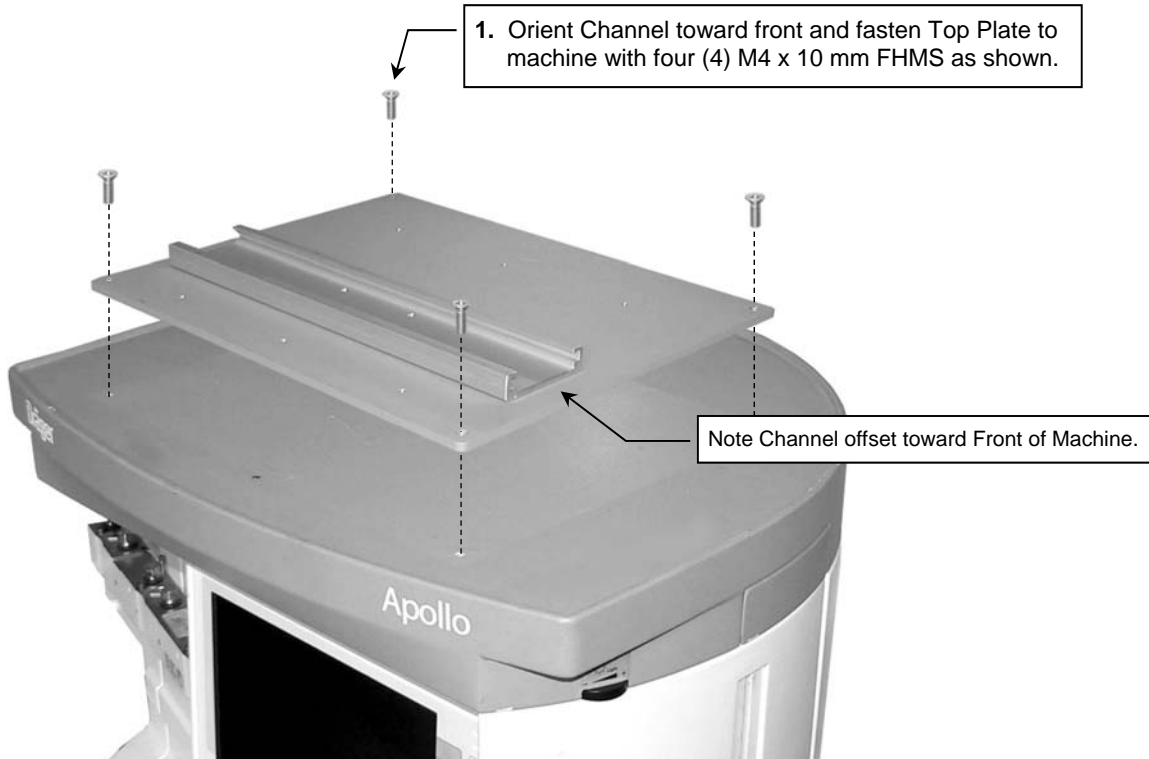

Installing the Low Profile Column Channel Mount

The following parts and hardware are included in this installation kit (hardware not shown):

Item #	Description	Qty
1	Low Profile Column with Channel Mount	1
2	M6 x 8mm Flat Head Machine Screw (FHMS)	2
3	M6 x 12mm FHMS	1
*4	Spacer	1
*5	M6 x 16mm PHMS	2

*See "Non-Table Mount" on page 4 for use of these parts.

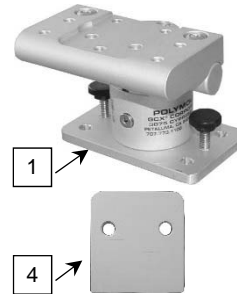

Tools Required

- Phillips screwdriver

1. Slide the Low Profile Column Channel Mount into the channel and move to desired mounting position.
2. Tighten two (2) thumb screws to secure position in channel.

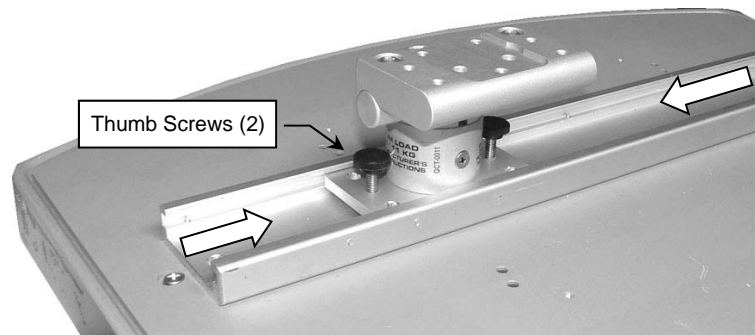

3. Fasten Philips-supplied Table Mount to Mounting Adapter with one (1) M6 x 12mm FHMS and two (2) M6 x 8mm FHMS (see below)..

Installation Note: Do not attach the Table Mount to the Mounting Adapter if you will be mounting a monitor equipped with the mounting interface shown in photo (right). See "non-Table Mount" (page 4) for instructions specific to this type of mounting plate.

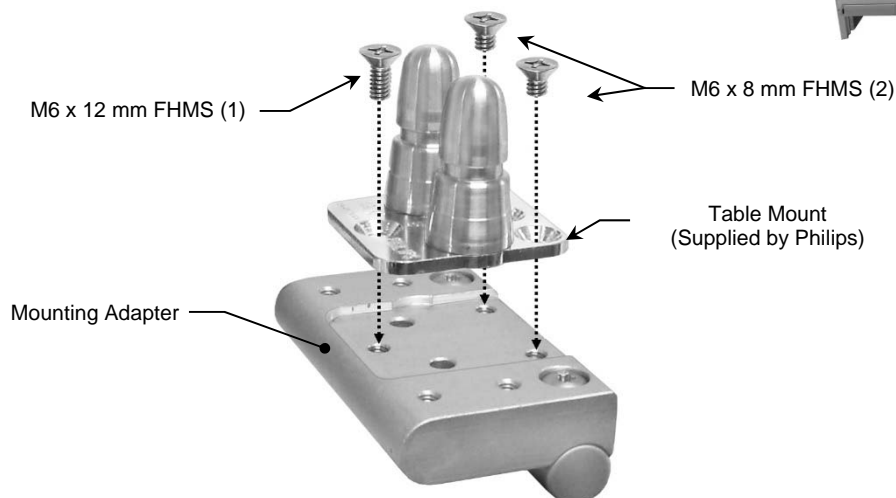
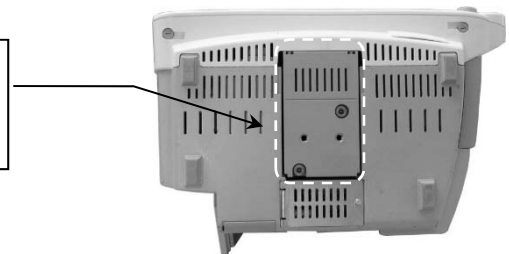

Non-Table Mount

1. Fit Spacer into recessed area on top of Mounting Adapter (below). Ensure Spacer remains between Mounting Adapter and monitor.
2. Insert two (2) M6 x 16mm PHMS through bottom of Mounting Adapter and thread into mounting holes in bottom of monitor.

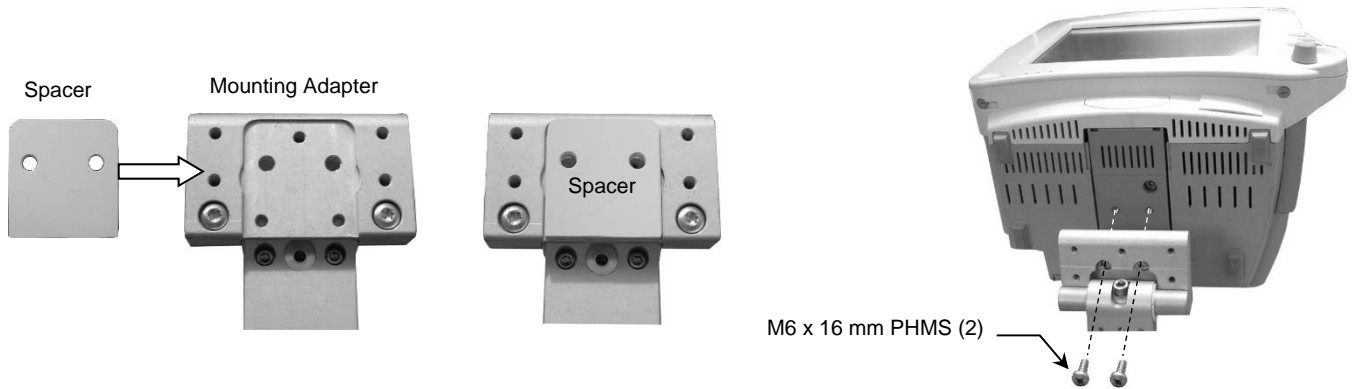

Mounting the MX400/450/500/550 Monitor (Fixed Mount Adapter)

Mount the monitor in accordance with separate Installation Guide DU-PH-0073-15 provided with the Mounting Adapter, ordered separately.

Routine Maintenance

Periodically inspect all fasteners associated with the mounting system. Tighten or adjust fasteners as necessary for optimal operation and safety.

Cleaning the Mounting Assembly

1. The mounting assembly may be cleaned with most mild, non-abrasive solutions commonly used in the hospital environment (e.g. diluted bleach, ammonia, or alcohol solutions).
2. The surface finish will be permanently damaged by strong chemicals and solvents such as acetone or trichloroethylene.
3. Do not use Steel wool or other abrasive material.
4. Damage caused by the use of unapproved substances or processes will not be warranted. It is recommended that you test any cleaning solution on a small area of the arm that is not visible to verify compatibility.
5. Never submerge or allow liquids to enter the mounting assembly. Wipe any cleaning agents off of the arm immediately, using water dampened cloth. Dry the assembly thoroughly after cleaning.

CAUTION: GCX makes no claims regarding the efficacy of the listed chemicals or processes as a means for controlling infection. Consult your hospital's infection control officer or epidemiologist. To clean or sterilize mounted devices or accessory equipment, refer to the specific instructions delivered with those products before installing the arm in the Channel.