

Installation Guide

Additional 10 lbs. Counterweight for VHRC

Item #	Description	Qty
1	10 lbs. Counterweight	1
2	5/16-18 x 1 3/4" Hex Head Cap Screw (HHCS)	2
3	Split Lock Washer	2
4	Flat Washer	2

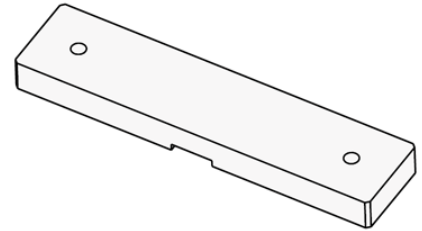

Tools Required:

- 1/2" Socket Wrench

Attaching 10 lbs. Counterweight to VHRC

1. Align the (2) mounting holes on the 10 lbs. counterweight with the (2) threaded holes on the VHRC counterweights.
2. Using a 1/2" Socket Wrench, secure 10 lbs. Counterweight to VHRC counterweights with (2) 5/16-18 x 1 3/4" HHCS, (2) Split Lock Washers and (2) Flat Washers.

