

Installation Guide

Roll Stand Cylinder Mount (2" Diameter Roll Stand Post) (3.5" - 4.5" Diameter Cylinder) (Maximum Cylinder Weight – 17.5 Pounds Full)

The purpose of this guide is to describe the attachment of the Cylinder Mount to a 2" diameter Roll Stand Post.

MRI Application Note

This product is made from all non-magnetic or low magnetic property materials and therefore may be suitable for MRI applications. However, it is the responsibility of the healthcare institution to verify and validate the appropriateness for use of this product within an MRI environment.

Tip Stability Warning

GCX manufactures mounting hardware for a variety of patient monitoring equipment and related devices. The configurations shown here are provided for reference only and are intended to show typical components available to build a complete workstation. Due to the many variations in patient monitoring equipment and related devices, GCX makes no claims regarding the tip stability or overall safety of the final customer configuration. It is the responsibility of the healthcare institution to ensure that the final product configuration is stable and safe. Customers are encouraged to contact GCX for assistance with tip stability testing of final product configurations.

Parts Reference

The following parts and hardware are included in this kit (hardware not shown).

Item #	Description	Qty
1	Cylinder Cup Assembly	1
2	Cylinder Cradle Assembly	1
3	Roll Stand Clamping Block	2
4	10-32 x 5/8 Pan Head Machine Screw (PHMS)	4

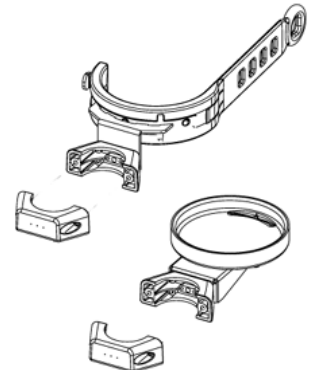

Tools Required – Phillips screwdriver

Attaching Cylinder Mount to Post

Position and attach Cup Assembly to Roll Stand Post using (1) Clamping Block and (2) 10-32 x 5/8 PHMS. Tighten screws equally to secure Cup Assembly to post. Position and attach Cradle Assembly to Roll Stand Post using (1) Clamping Block and (2) 10-32 x 5/8 PHMS. Tighten screws equally to secure Cradle Assembly to post.

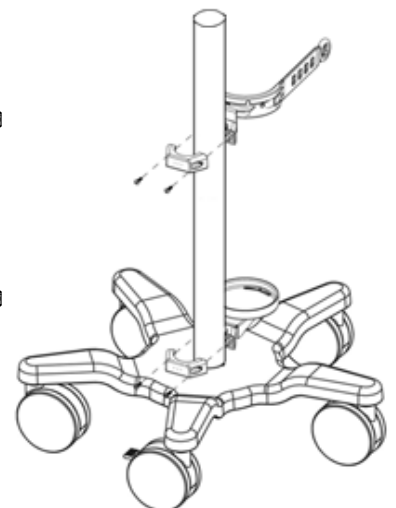
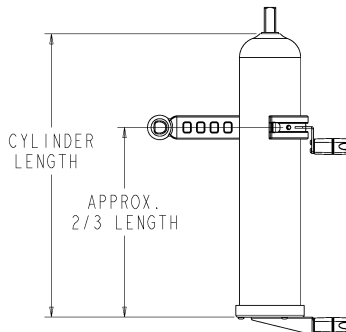

Securing Cylinder

Position Cylinder in Cup Assembly and secure by stretching rubber strap of Cradle Assembly around Cylinder and securing to hook on other side of Cradle Assembly.

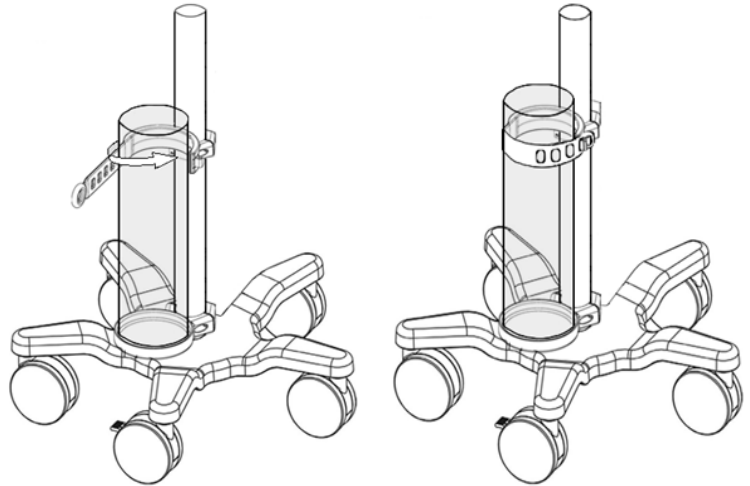

Routine Maintenance

Periodically inspect all hardware associated with the mounting system. Tighten or adjust as necessary for optimal operation and safety.

Cleaning the Mounting Assembly

1. The mounting assembly may be cleaned with most mild, non-abrasive solutions commonly used in the hospital environment (e.g. diluted bleach, ammonia, or alcohol solutions).
2. The surface finish will be permanently damaged by strong chemicals and solvents such as acetone and trichloroethylene.
3. Do not use steel wool or other abrasive material to clean the mounting assembly.
4. Damage caused by the use of unapproved substances or processes will not be covered by warranty. We recommend testing of any cleaning solution on a small area of the mounting system that is not visible to verify compatibility.
5. Wipe any cleaning agents off of the mounting system immediately using a water dampened cloth. Dry the mounting system thoroughly after cleaning.

CAUTION: GCX makes no claims regarding the efficacy of the listed chemicals or processes as a means for controlling infection. Consult your hospital's infection control officer or epidemiologist. To clean or sterilize mounted instruments or accessory equipment, refer to the specific instructions delivered with those products.