

## Installation Guide

### 16" M-Series Arm for Mounting Spacelabs Portable Monitors on Anesthesia Machines

The purpose of this guide is to:

1. Describe mounting of M-Series Arm in Channel (page 1).
2. Describe attachment of Utility Hook to Arm (page 2).
3. Describe mounting of monitor and modification to Mounting Plate for bottom-mounted monitors (page 2).
4. Describe adjustments to the M-Series Arm (page 3).

### Parts Reference

The following parts and hardware are included in this installation kit (hardware may not be shown):

Item #	Description	Qty
1	M-Series Arm, 16" with Slide-on Mounting Plate	1
2	Utility Hook	1
3	#10-32 x 3/4" Socket Head Cap Screw (SHCS)	3
4	1/8" Hex Wrench	1
5	5/32" Hex Wrench	1
6	Tilt Limit Screw (5/16-18 x 1/2" Socket Head)	1
7	1/4" Hex Wrench	1
8	Wall Channel Cover, 16" (includes instructions)	1
9	Adjustable Stop	1

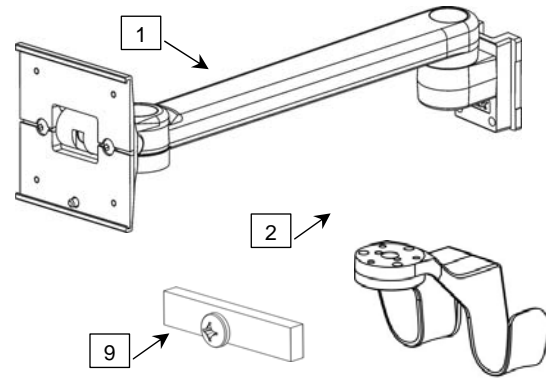

### Tools Required

1/8", 5/32", and 1/4" hex wrenches (provided), Phillips screwdriver (not provided).

### Mounting M-Series Arm in Channel on Left Side of Anesthesia Machine

1. Lower Adjustable Stop into channel to desired position. Using a Phillips screwdriver, tighten center screw to secure position (below left).
2. Install Arm by guiding Slide (rear of Arm) into top of Channel. Slide Arm to desired position in channel and tighten two (2) set screws (bottom of Slide) with the 1/8" hex wrench provided.

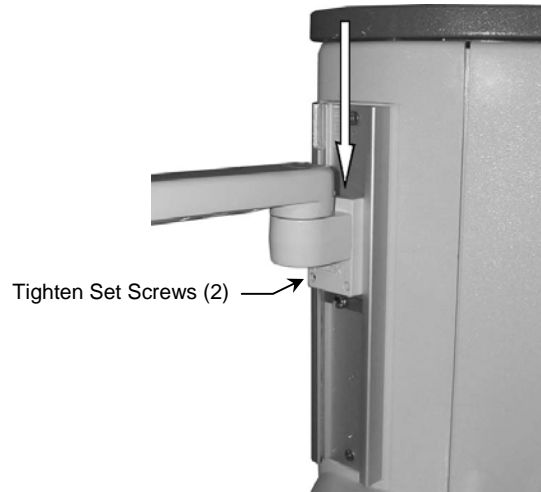
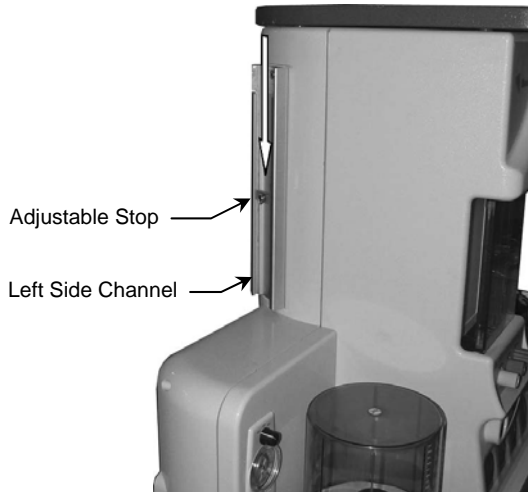

## Attaching Utility Hook to M-Series Arm

1. Align three (3) mounting holes in the Utility Hook with corresponding threaded holes in Lower Swivel Fitting on bottom of Arm. Using the 5/32" [4 mm] hex wrench provided, fasten Hook to Swivel Fitting with three (3) 10-32 x 3/4" SHCS.

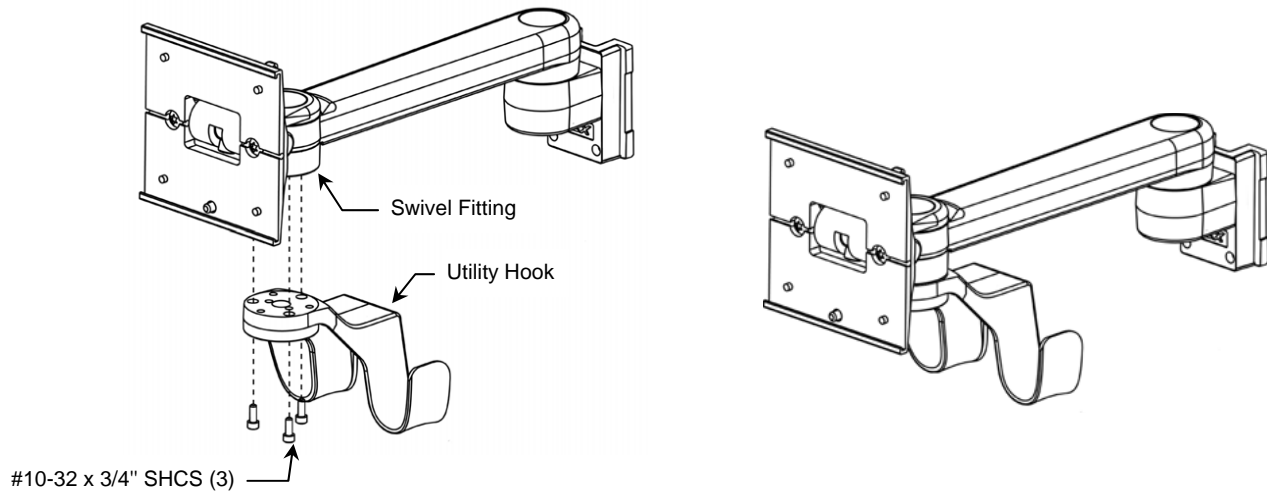

## Mounting the Monitor

The Mounting Adapter for the monitor is not included in this installation kit. Mount the monitor in accordance with the installation guide included with the Mounting Adapter. **Installation Note:** The Mounting Plate on the M-Series Arm is pre-configured at the factory for rear-mounted monitors. For bottom-mounted monitors please perform the following modification to the Mounting Plate.

1. Tilt the Mounting Plate forward and remove the Tilt Adjustment Lever by turning counterclockwise (below left).
2. Tilt the Mounting Plate toward the rear until horizontal (below center and right).
3. Using the 1/4" hex wrench provided, install the Tilt Limit Screw in the tilt bar as shown below right. Mount the monitor in accordance with the installation guide included with the Mounting Adapter.

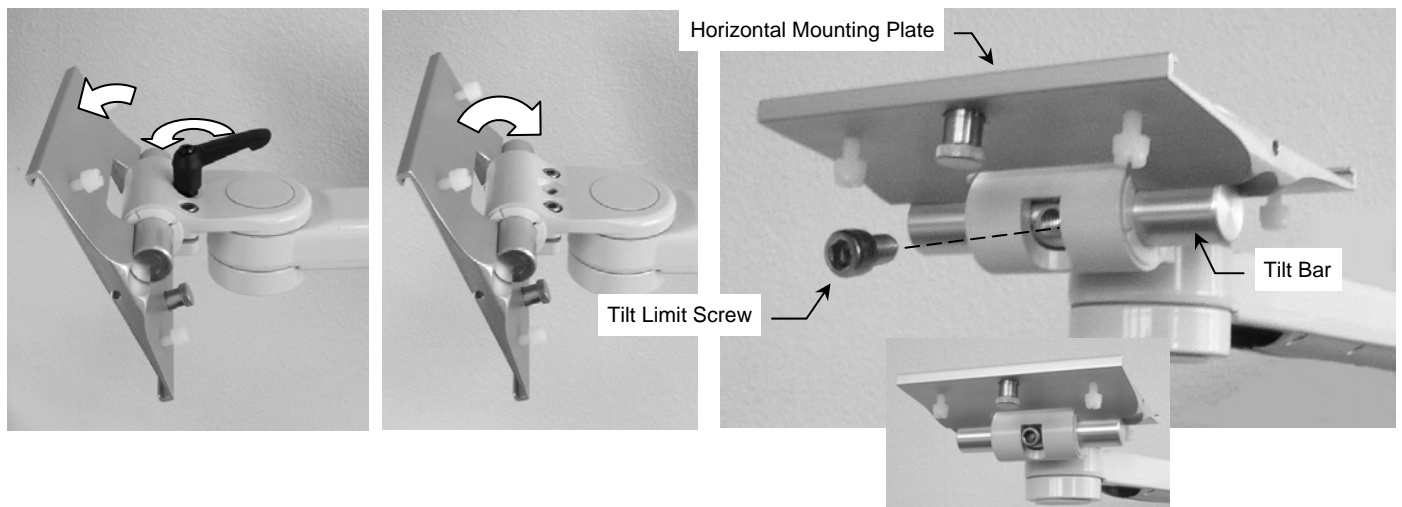

## Installing the Wall Channel Cover

Install the Wall Channel Cover in accordance with the *Channel Cover Installation Guide (DU-UT-0001-20)*.

## M-Series Arm Adjustments

**Adjusting Tilt:** Turn Tilt Adjustment Lever counterclockwise to loosen. Lever provides ratchet-style adjustment (see *Installation Note* below). Grasp device and tilt to the desired angle. Turn Tilt Adjustment Lever clockwise (using ratchet feature) to tighten and lock position.

**Adjusting Tilt Tension:** Adjust the overall tilting tension by equally tightening or loosening two (2) Tilt Tension Screws with the 5/32" hex key provided. Once tilt tension is set, use the Tilt Adjustment Lever to fine tune and lock the tilt position.

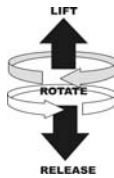
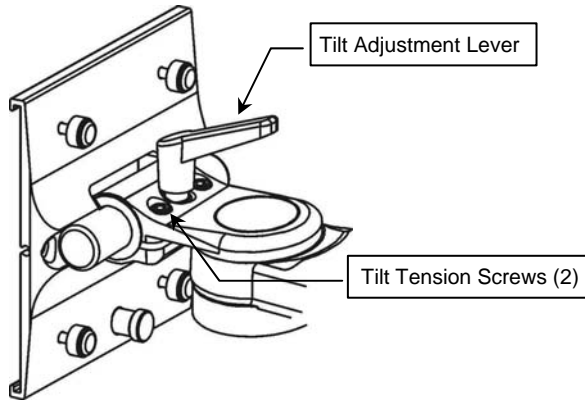

**Installation Note:** The Tilt Adjustment Lever is a multi-position clamping lever that operates by lifting, rotating, and releasing the handle.

## Adjusting Swivel Tension (see photo below left)

1. Using 5/32" hex wrench, remove Utility Hook (not shown).
2. Tighten or loosen Swivel Tension Nut using a 1/2" [13 mm] socket wrench.
3. Reinstall Utility Hook (not shown).

## Adjusting Pivot Tension (below)

Using a 1/2" [13 mm] socket wrench, tighten or loosen Pivot Tension Bolt (see below).

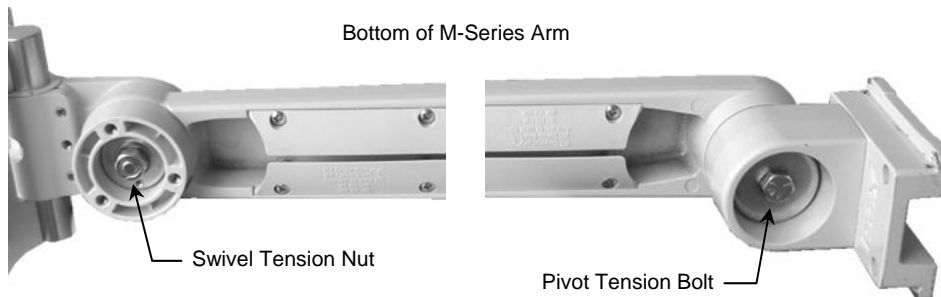

## Periodic Maintenance

All fasteners associated with the mounting system should be inspected periodically and tightened as necessary for optimal operation and safety.

## Cleaning the Mounting Assembly

1. The mounting assembly may be cleaned with most mild, non-abrasive solutions commonly used in the hospital environment (e.g. diluted bleach, ammonia, or alcohol solutions).
2. The surface finish will be permanently damaged by strong chemicals and solvents such as acetone or trichloroethylene.
3. Steel wool or other abrasive material should never be used.
4. Damage caused by the use of unapproved substances or processes will not be warranted. We recommend testing of any cleaning solution on a small area of the arm that is not visible to verify compatibility.
5. Never submerge or allow liquids to enter the arm. Wipe any cleaning agents off the arm immediately using a water-dampened cloth. Dry the arm thoroughly after cleaning.

**CAUTION:** GCX makes no claims regarding the efficacy of the listed chemicals or processes as a means for controlling infection. Consult your hospital's infection control officer or epidemiologist. To clean or sterilize mounted devices or accessory equipment, refer to the specific instructions delivered with those products.