

Installation Guide

Dual Channel Variable Height Roll Stand, 18"/200N, 21" Base with 10 lb. Counterweight

The purpose of this guide is to describe assembly of the Roll Stand.

Parts Reference

The following parts and hardware are included in this installation kit:

Item #	Description	Qty
1	Dual Channel Roll Stand Post, 18"	1
2	Roll Stand Base (with 10 lb. Counterweight)	1
3	Foot Pedal Assembly	1
4	1/4-20 x 3/4" Socket Head Cap Screw (SHCS)	2
5	Channel Cover, 16" L x 2" W (not shown)	2
6	Channel Cover, 16" L x 1" W (not shown)	2
7	3/16" Hex Wrench (not shown)	1

Tools required: 3/16" hex wrench (provided).

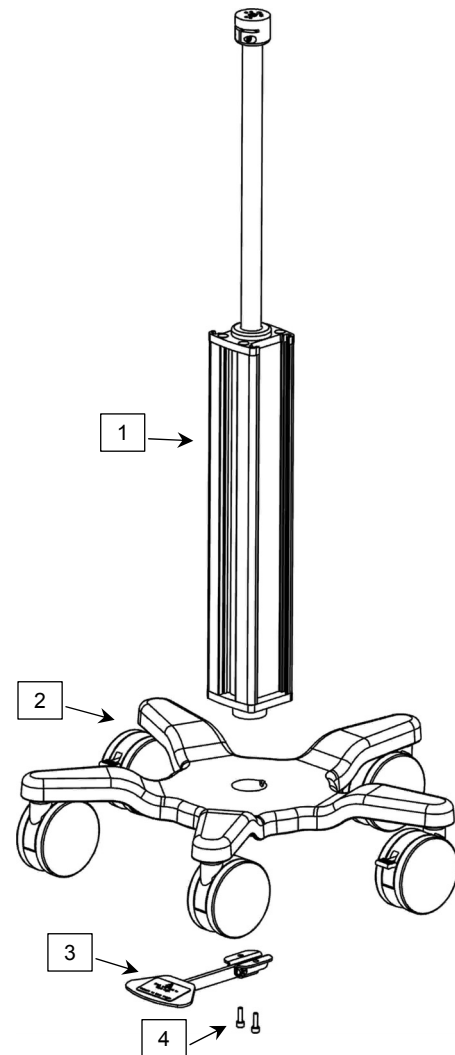

Assembling Post, Base, and Foot Pedal

1. Set Base on floor. Align 1" Channel as front of Post. Insert Post in Base and carefully lay assembly on its side for access to bottom of Base.
2. Align Foot Pedal between two legs of Base as shown below. Using the 3/16" hex wrench provided, fasten Foot Pedal – Base – Post assembly together with two (2) 1/4-20 x 3/4" SHCS (below right).

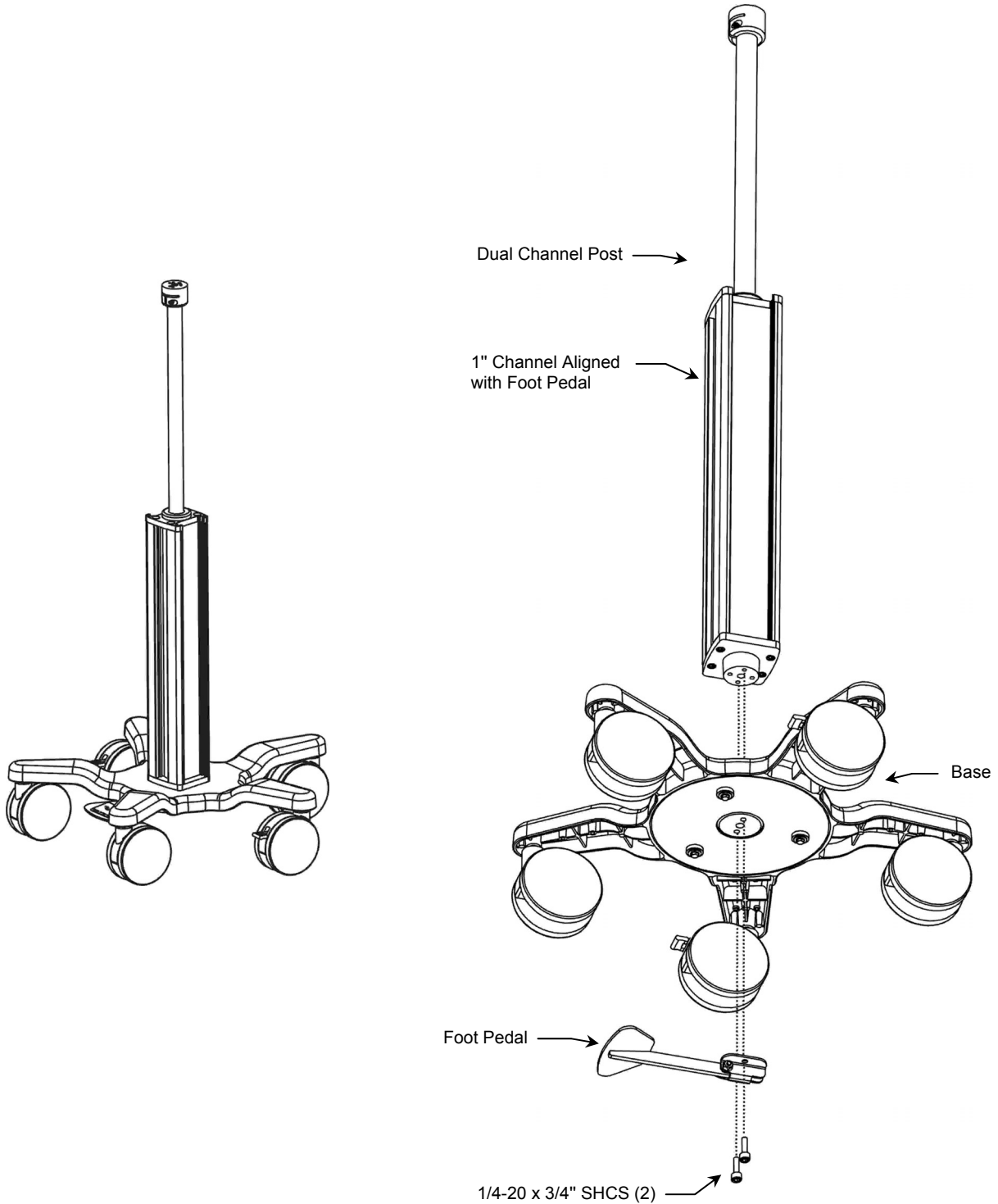

Installing Channel Covers (not shown)

Channel Covers are provided for both the 2-inch and 1-inch wide channels. Channel Covers serve both as an aesthetic cover and may be used for cable management along the channels.

Channel Covers are typically installed after an *enclosure or other *mounting system has been attached to the top of the Roll Stand Post and mounted in the channels. Install Channel Covers in accordance with separate installation guide.

**A variety of enclosures and mounting systems are available but not included with this roll stand kit.*

Routine Maintenance

Periodically inspect all mounting hardware. Tighten or adjust as necessary for optimal operation and safety.

Cleaning the Mounting Assembly

CAUTION: GCX makes no claims regarding the efficacy of the listed chemicals or processes as a means for controlling infection. Consult your hospital's infection control officer or epidemiologist. To clean or sterilize mounted instruments or accessory equipment, refer to the specific instructions delivered with those products.

1. The mounting assembly may be cleaned with most mild, non-abrasive solutions commonly used in the hospital environment (e.g. diluted bleach, ammonia, or alcohol solutions).
2. The surface finish will be permanently damaged by strong chemicals and solvents such as acetone and trichloroethylene.
3. Do not use steel wool or other abrasive material to clean the mounting assembly.
4. Damage caused by the use of unapproved substances or processes will not be covered by warranty. We recommend testing off any cleaning solution on a small area of the mounting assembly that is not visible to verify compatibility.
5. Never submerge the roll stand or allow liquids to enter the mounting assemblies. Wipe any cleaning agents off the mounting assembly immediately using a water-dampened cloth. Dry all mounting assemblies thoroughly after cleaning.